



Madison, Wisconsin

# CITY OF MADISON

## CITY ENGINEERING DIVISION

### DEPARTMENT OF PUBLIC WORKS

# PLAN OF PROPOSED IMPROVEMENT

# KENNEDY POINT CONDOMINIUMS PUD

WINNEBAGO STREET  
SOUTH FIRST STREET  
EASTWOOD DRIVE

PROJECT NO. 53B2046  
CONTRACT NO. 2046

#### CONVENTIONAL SIGNS

COMBUSTIBLE FLUIDS

UNDERGROUND UTILITIES

GAS

ELECTRIC

TELEPHONE OR TELEGRAPH

STORM SEWER

SANITARY SEWER

WATER

FIBER OPTICS TELEPHONE

POWER POLE

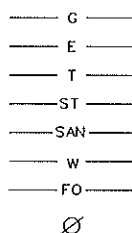

#### INDEX OF SHEETS

SHEET NO.	TITLE
1	STANDARD NOTES, TYPICAL SECTIONS AND DETAILS
D-1 - D-3	STREET PLAN AND PROFILE
P-101 - P-102	CONCRETE PAVEMENT PLAN
P-103	UTILITY PLAN AND PROFILE
U-101 - U-102	STORM SEWER SCHEDULE
U-103	WATER PLAN AND PROFILE
W-101	

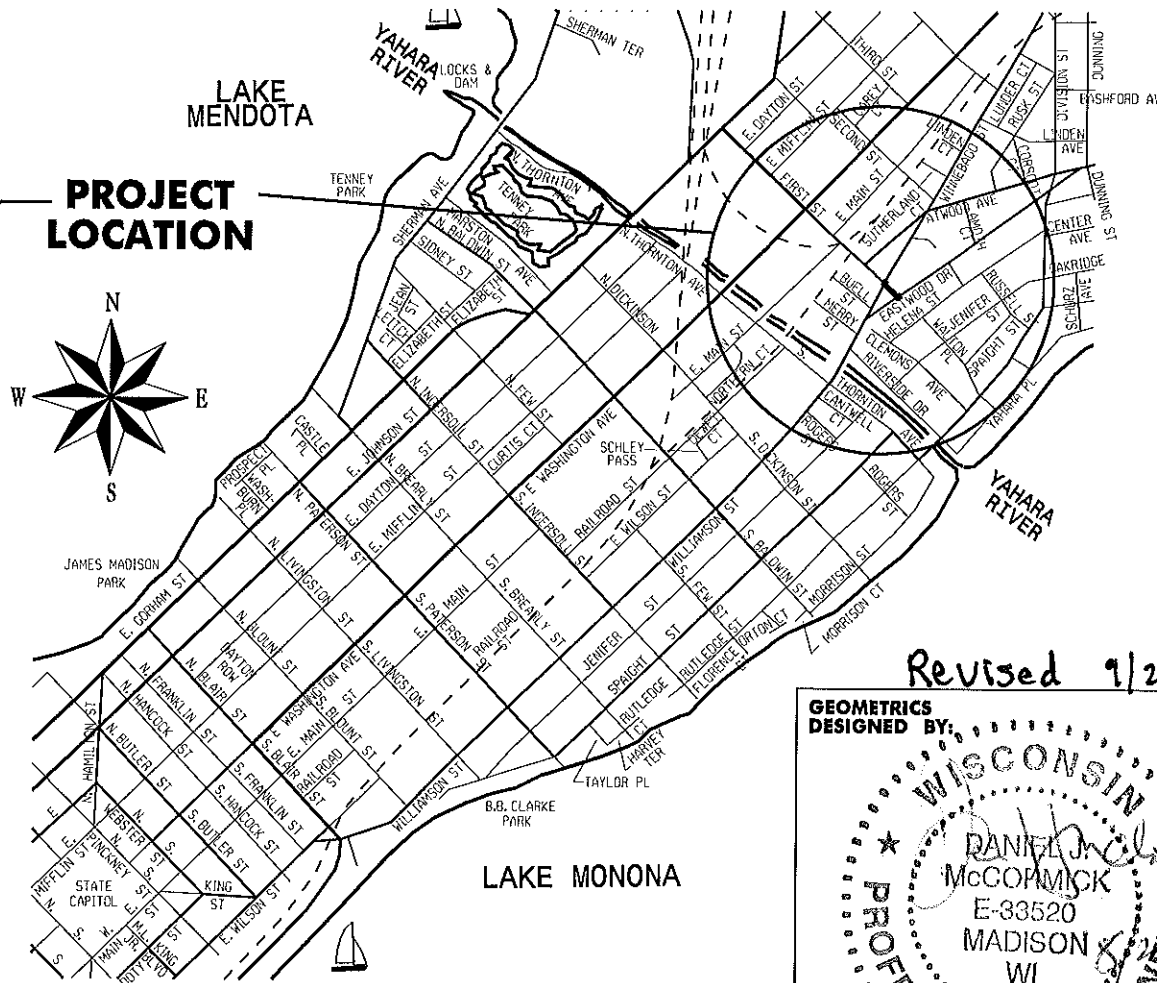
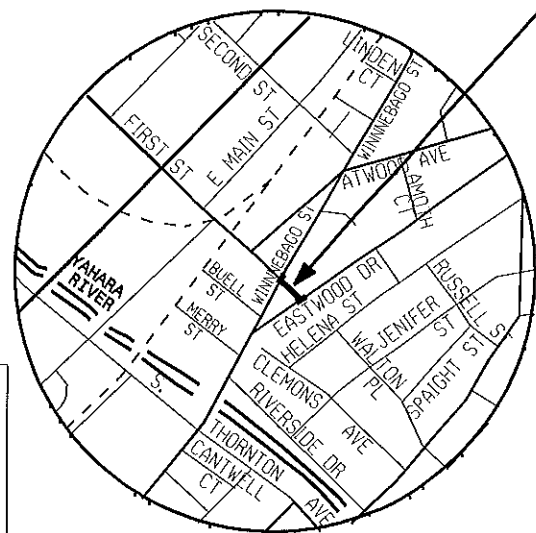

**THIS PLAN IS FOR  
WORK IN THE  
RIGHT-OF-WAY ONLY.**

**NOTE: INSTALLATION OF STREET AND TRAFFIC LIGHTING IS REQUIRED WITH THIS TERRACE RESTORATION PROJECT. AN ELECTRICAL PLAN FOR STREET AND TRAFFIC LIGHTING WILL BE ISSUED BY CITY TRAFFIC ENGINEERING AT A FUTURE DATE. CONTACT DAN DETTMANN OF CITY TRAFFIC ENGINEERING (266-6536) FOR INFORMATION.**

PUBLIC IMPROVEMENT PROJECT APPROVED  
NOVEMBER 8, 2005  
BY THE COMMON COUNCIL  
OF MADISON, WISCONSIN

PUBLIC IMPROVEMENT PROJECT  
APPROVED BY:  
*[Signature]* 8/24/06  
City Engineer Date

STREET GRADES  
DESIGNED BY:  
  
*[Signature]* 8/24/06

SANITARY SEWER  
DESIGNED BY:  
  
*[Signature]* 6-28-06

STORM SEWER  
DESIGNED BY:  
  
*[Signature]*

Revised 9/22/06

GEOMETRICS  
DESIGNED BY:  
  
*[Signature]*

WATER  
DESIGNED BY:  
  
*[Signature]* 08/23/06

ALL CONCRETE PAVEMENT SHALL BE CONSTRUCTED PER ARTICLE 404 OF THE STANDARD SPECIFICATIONS.  
ALL ASPHALT PAVEMENT SHALL BE TYPE "C" PER STANDARD DETAIL DRAWING 4.02.

ALL ISLANDS SHALL HAVE TYPE "E" C & G PER S.D.D. 3.08 AND MOUNTABLE NOSES PER S.D.D. 3.13. ALL OTHER C & G SHALL BE TYPE "A" PER S.D.D. 3.06.

ISLAND INTERIORS SHALL BE OF SOD WHERE THE BACK TO BACK OF CURB DIMENSION IS GREATER THAN 6'.

UNDERDRAINS SHALL BE INSTALLED, PER STANDARD DETAIL DRAWING 4.05, ON PAGE 2 OF THESE PLANS, FOR 75' ON EACH SIDE OF THE LOW POINT, OR TO THE NEAREST CURB HIGH POINT. ALL UNDERDRAIN SHALL BE WRAPPED.

ALL GUTTERS SHALL DRAIN WITH A MINIMUM GRADES OF 0.5% TOWARD STORM SEWER INLETS.

PAVEMENT CROSS SLOPES SHALL BE 2%, TERRACES SHALL SLOPE AT A 4% GRADE TOWARD THE GUTTER, SHOULDERS SHALL HAVE A 4% CROSS SLOPE AND CROSS SLOPES FORMING DITCHES SHALL NOT EXCEED 4.00:1 UNLESS OTHERWISE INDICATED.

THE CROSS SLOPE OF SIDEWALKS AND BARRIER FREE SIDEWALK CURB RAMPS SHALL BE 2%. THE LONGITUDINAL GRADE OF BARRIER FREE SIDEWALK CURB RAMPS SHALL NOT EXCEED 8.33%. ALL SIDEWALK RAMPS SHALL BE CONSTRUCTED ACCORDING TO S.D.D. 3.03. AT ALL OTHER LOCATIONS THE LONGITUDINAL GRADE OF SIDEWALKS SHALL NOT EXCEED 5.0 % OR THE ADJACENT STREET GRADE WHICHEVER IS GREATER NOR BE LESS THAN 0.5% AND SHALL DRAIN TOWARD STORM SEWER INLETS. A 2 FOOT WIDE CONCRETE FLUME SHALL BE INSTALLED BETWEEN THE SIDEWALK AND THE BACK OF CURB AT SIDEWALK LOW POINTS WHICH CANNOT OTHERWISE BE DRAINED DIRECTLY TO THE GUTTER. SIDE SLOPES WITHIN TEN FEET OF A PUBLIC SIDEWALK SHALL NOT EXCEED 4.00:1. THE DESIGN OF SIDEWALK ELEVATIONS AND GRADES IS NOT INCLUDED IN THIS PLAN. ALL SIDEWALK AND SIDEWALK RAMP ELEVATIONS AND GRADES SHALL BE FIELD VERIFIED AND SET TO COMPLY WITH THE CITY OF MADISON STANDARD SPECIFICATIONS AND THE A.D.A. GUIDELINES.

OBTAIN A PRINT OUT OF THE ALIGNMENT FROM THE CITY ENGINEER PRIOR TO STAKING THIS PROJECT.

CURB STATION AND OFFSETS SHALL BE TO THE FACE OF CURB UNLESS OTHERWISE INDICATED. CURB ELEVATIONS SHALL BE TO THE TOP OF CURB (OR EXTENDED TOP OF CURB FOR DRIVEWAYS OR RAMPS) UNLESS OTHERWISE INDICATED.

POWER POLES AND OTHER OBSTRUCTIONS SHALL BE MOVED TO PROVIDE 2 FEET MINIMUM OF CLEAR DISTANCE FROM ANY FACE OF CURB OR EDGE OF SIDEWALK.

ANY INFORMATION SHOWN ON THIS PLAN, WHICH IS NOT PART OF THIS PROJECT, IS PRELIMINARY AND NOT FOR CONSTRUCTION.

THERE MAY BE EXISTING UTILITIES OR OTHER FEATURES WHICH ARE EITHER NOT SHOWN OR SHOWN INCORRECTLY ON THIS PLAN. IT IS THE RESPONSIBILITY OF THE DEVELOPER TO LOCATE AND IDENTIFY ALL UTILITIES AND TOPOGRAPHY WHICH MAY AFFECT THE CONSTRUCTION OF THESE IMPROVEMENTS.

ALL PERMANENT SIGNING AND POSTING WILL BE DETERMINED AND PROVIDED BY THE TRAFFIC ENGINEERING DIVISION, FOLLOWING CONSTRUCTION OF THESE IMPROVEMENTS.

THE DEVELOPER SHALL PROVIDE, INSTALL AND MAINTAIN ALL STREET END BARRICADES, SIGNING AND TRAFFIC CONTROL, AS REQUIRED BY THE CITY TRAFFIC ENGINEER.

PAVEMENT SAWCUTS SHALL BE AS DIRECTED BY THE CITY CONSTRUCTION ENGINEER. SAWCUTS SHOWN ON THE PLAN ARE APPROXIMATE.

CURB ON CUL DE SACS SHALL BE INSTALLED ACCORDING TO SDD 3.05.

THE LOCATION AND INFORMATION FOR PROPOSED NEW TREES, IN THE PUBLIC RIGHT OF WAY OR ON PUBLIC LANDS ARE APPROXIMATE AND ARE SHOWN FOR REFERENCE ONLY. THE LOCATIONS, SPECIFICATIONS AND PLANTING METHODS OF ALL PROPOSED NEW OR REPLACEMENT TREES IN THE PUBLIC RIGHT OF WAY OR ON PUBLIC LANDS SHALL BE APPROVED BY THE CITY FORESTER PRIOR TO INSTALLATION.

NO TREES IN THE RIGHT OF WAY OR ON PUBLIC LANDS SHALL BE TRIMMED, PRUNED, REMOVED OR ADVERSELY AFFECTED IN ANY WAY UNTIL THE DEVELOPER HAS RECEIVED WRITTEN PERMISSION FROM THE CITY ENGINEER OR CITY FORESTER. SAID WRITTEN PERMISSION SHALL INCLUDE LANGUAGE INDICATING THAT SECTION 10.101 OF THE MADISON GENERAL ORDINANCES AND ADMINISTRATIVE PROCEDURE MEMORANDUM NO. 6-2, REFERING TO NOTIFICATION OF PROPERTY OCCUPANTS AND/OR OWNERS, HAS BEEN COMPLIED WITH.

ALL PAVEMENT PATCHES SHALL COMPLY WITH THE FOLLOWING PAVEMENT PATCHING CRITERIA:

Pavement Patching Criteria

Criteria use on:

- Streets with pavement rating > 6
- Arterial Streets

1. Length of Patch

- a. Minimum 50 feet long
- b. Minimum of 15 feet beyond the excavation
- c. Where multiple patches are created and the separation between them is less than 100 feet, the patches shall be combined into a single patch.
- d. The patches shall be adjusted in the field to meet special conditions such as previous paving or patching limits.

2. Width of Patch (all dimensions are curb face to curb face)

a. All Streets Except Divided or one way roadways

- i. Street Width 0 to 24 feet wide - Patch entire street width
- ii. Street Width 25 to 37 feet wide - Patch one half the street width (curb to centerline of roadway). Note Utility Engineer may adjust paving limit to correspond with a painted centerline in situations where the painted centerline is not in the center of the street.
- iii. Street Width 38 feet and up - Patch width of entire lane for each lane which was disturbed by the excavation.
  - 1. If the lane is adjacent to a bike lane, include the bike lane. (except when there is a parking lane between the bike lane and the curb)
  - 2. If the lane is a bike lane and adjacent to a parking lane, include the parking lane.
  - 3. If the lane is a bike lane and not adjacent to a parking lane, include the adjacent travel lane.

b. Divided Roadways and One Way Streets

- i. Street 0 to 19 feet wide - Patch entire street width
- ii. Street Width 20 feet and up - Patch width of entire lane for each lane which was disturbed by the excavation.
  - 1. If the lane is adjacent to a bike lane, include the bike lane. (except when there is a parking lane between the bike lane and the curb)
  - 2. If the lane is a bike lane and adjacent to a parking lane, include the parking lane.
  - 3. If the lane is a bike lane and not adjacent to a parking lane, include the adjacent travel lane.

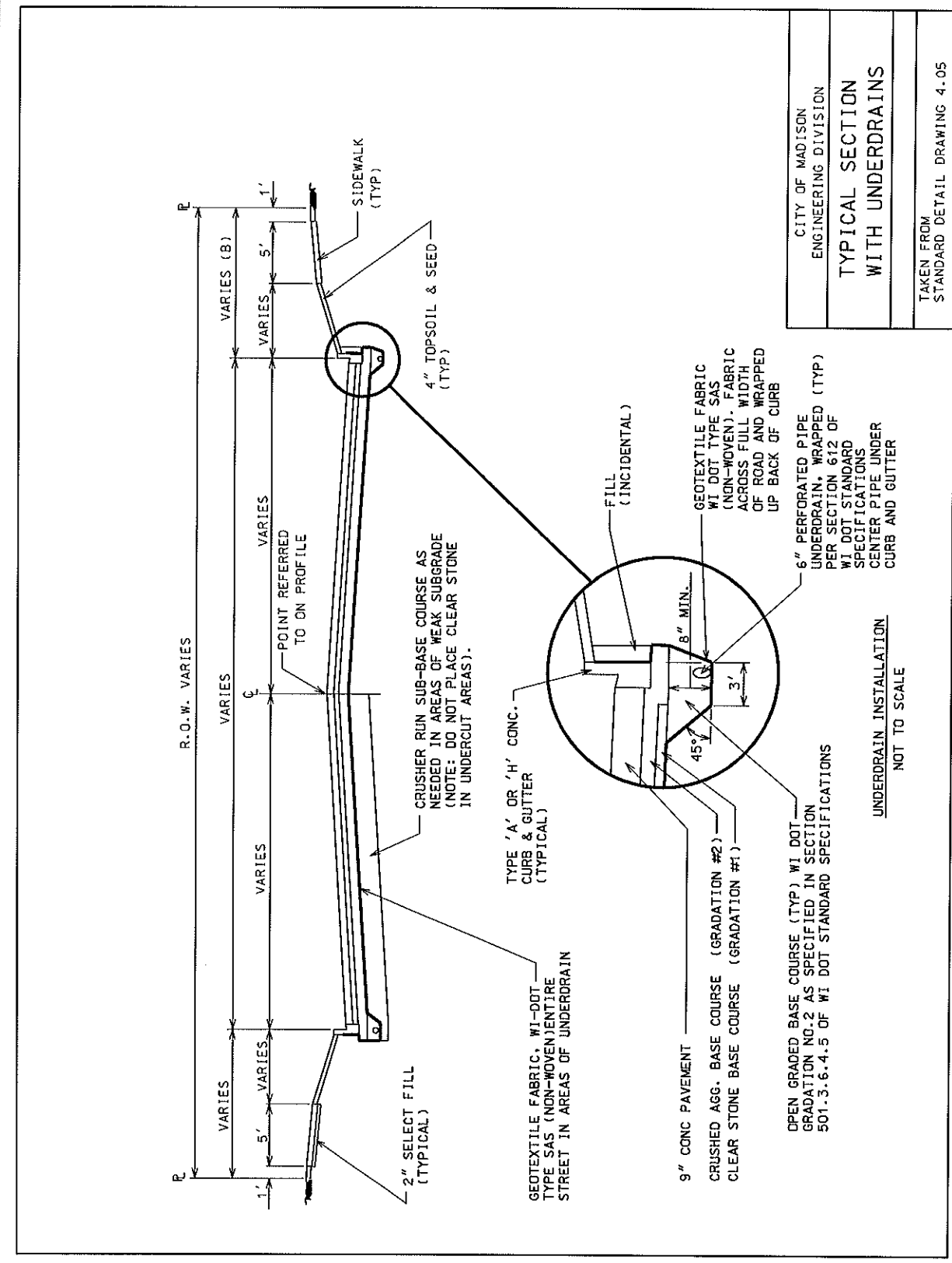

CITY OF MADISON  
 ENGINEERING DIVISION  
**TYPICAL SECTION  
 WITH UNDERDRAINS**  
 TAKEN FROM  
 STANDARD DETAIL DRAWING 4.05

1/8/98 M:\DESIGN\STREETS\CGM\STREETS\CITY\_SDD\ 4\_05.DGN

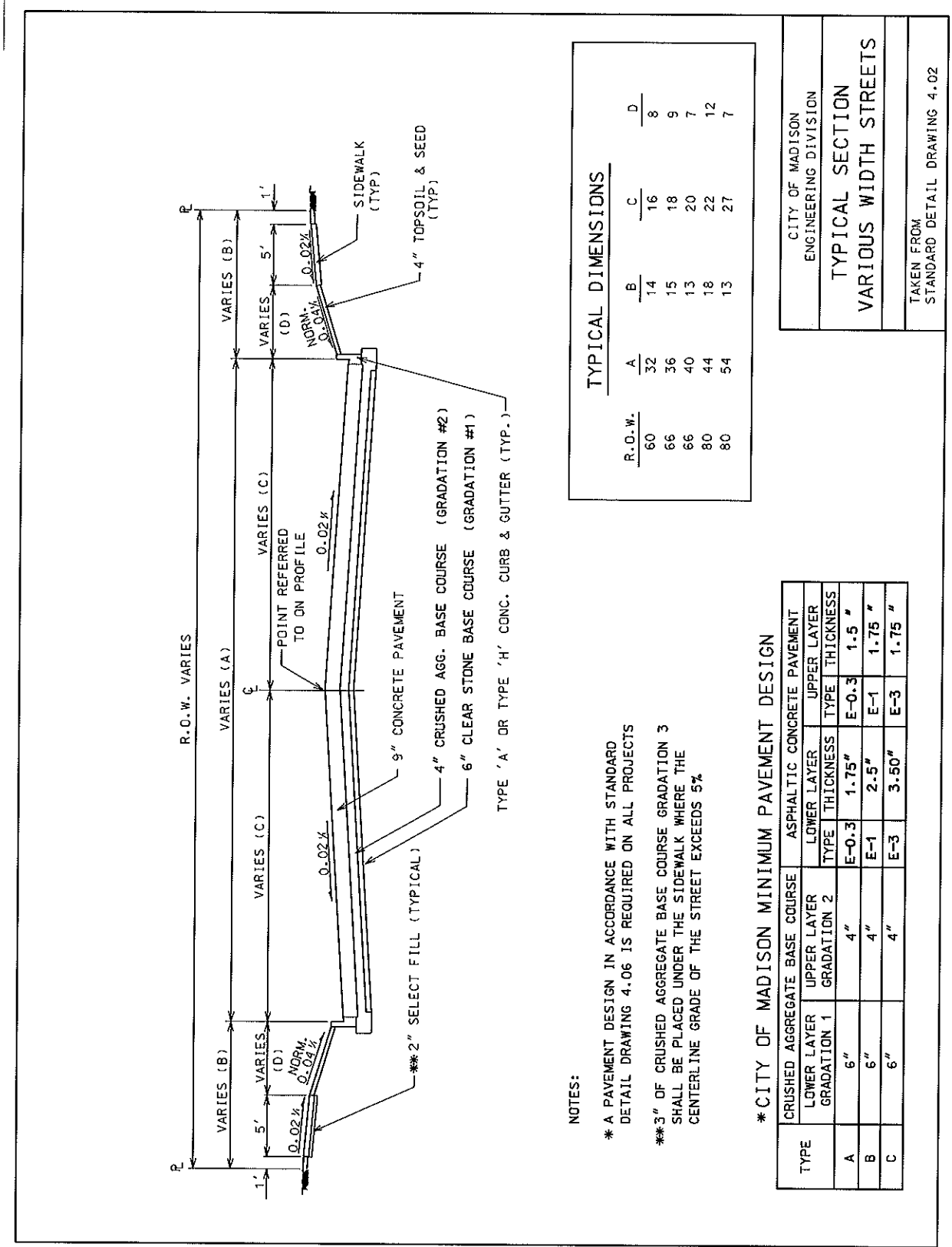

CITY OF MADISON  
 ENGINEERING DIVISION  
**TYPICAL SECTION  
 VARIOUS WIDTH STREETS**  
 TAKEN FROM  
 STANDARD DETAIL DRAWING 4.02

**TYPICAL DIMENSIONS**

R.O.W.	A	B	C	D
60	32	14	16	8
66	36	15	18	9
66	40	13	20	7
80	44	18	22	12
80	54	13	27	7

**\* CITY OF MADISON MINIMUM PAVEMENT DESIGN**

TYPE	CRUSHED AGGREGATE BASE COURSE		ASPHALTIC CONCRETE PAVEMENT	
	LOWER LAYER GRADATION 1	UPPER LAYER GRADATION 2	LOWER LAYER TYPE THICKNESS	UPPER LAYER TYPE THICKNESS
A	6"	4"	E-0.3 1.75"	E-0.3 1.5"
B	6"	4"	E-1 2.5"	E-1 1.75"
C	6"	4"	E-3 3.50"	E-3 1.75"

NOTES:  
 \* A PAVEMENT DESIGN IN ACCORDANCE WITH STANDARD DETAIL DRAWING 4.06 IS REQUIRED ON ALL PROJECTS  
 \*\*\*3" OF CRUSHED AGGREGATE BASE COURSE GRADATION 3 SHALL BE PLACED UNDER THE SIDEWALK WHERE THE CENTERLINE GRADE OF THE STREET EXCEEDS 5%.

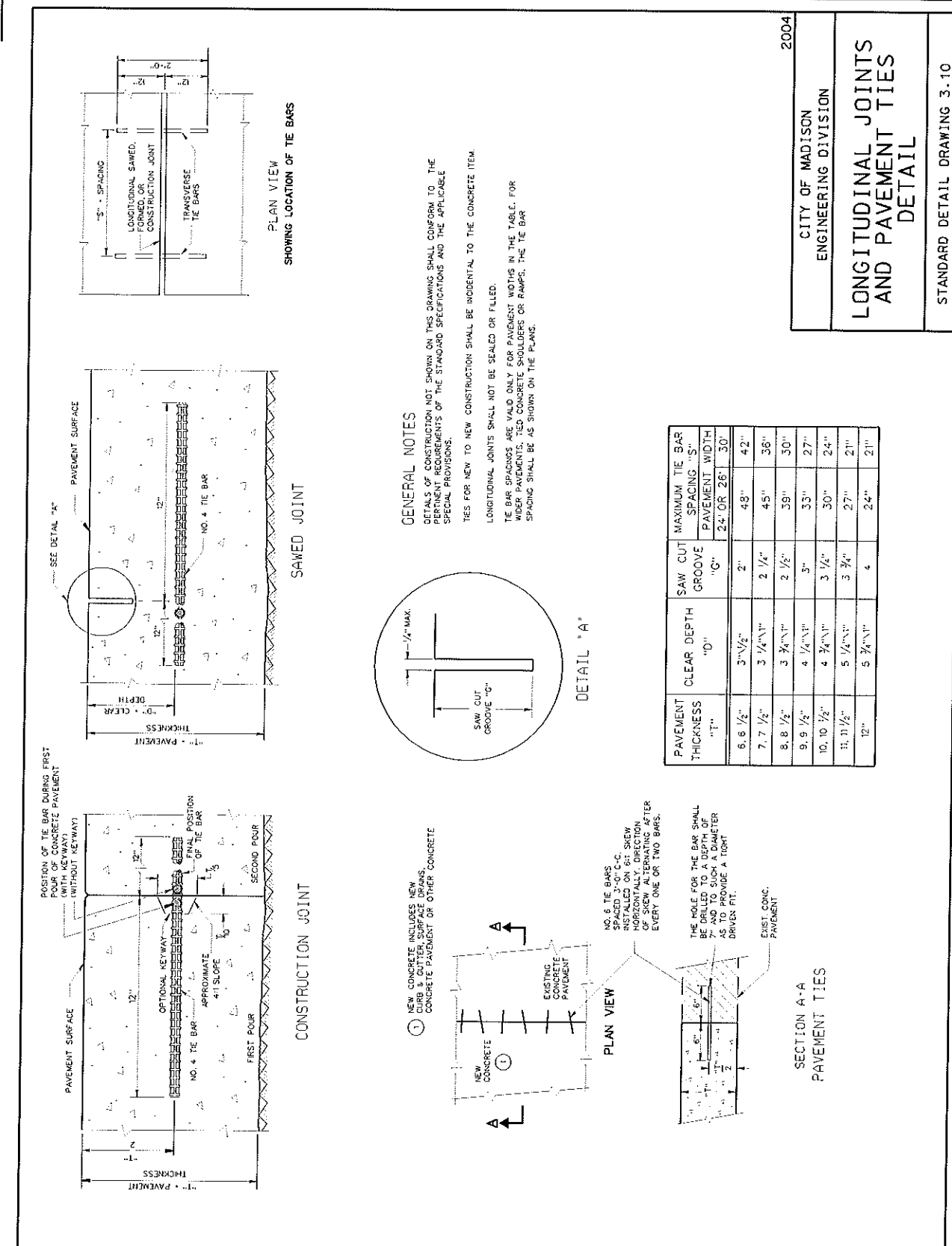
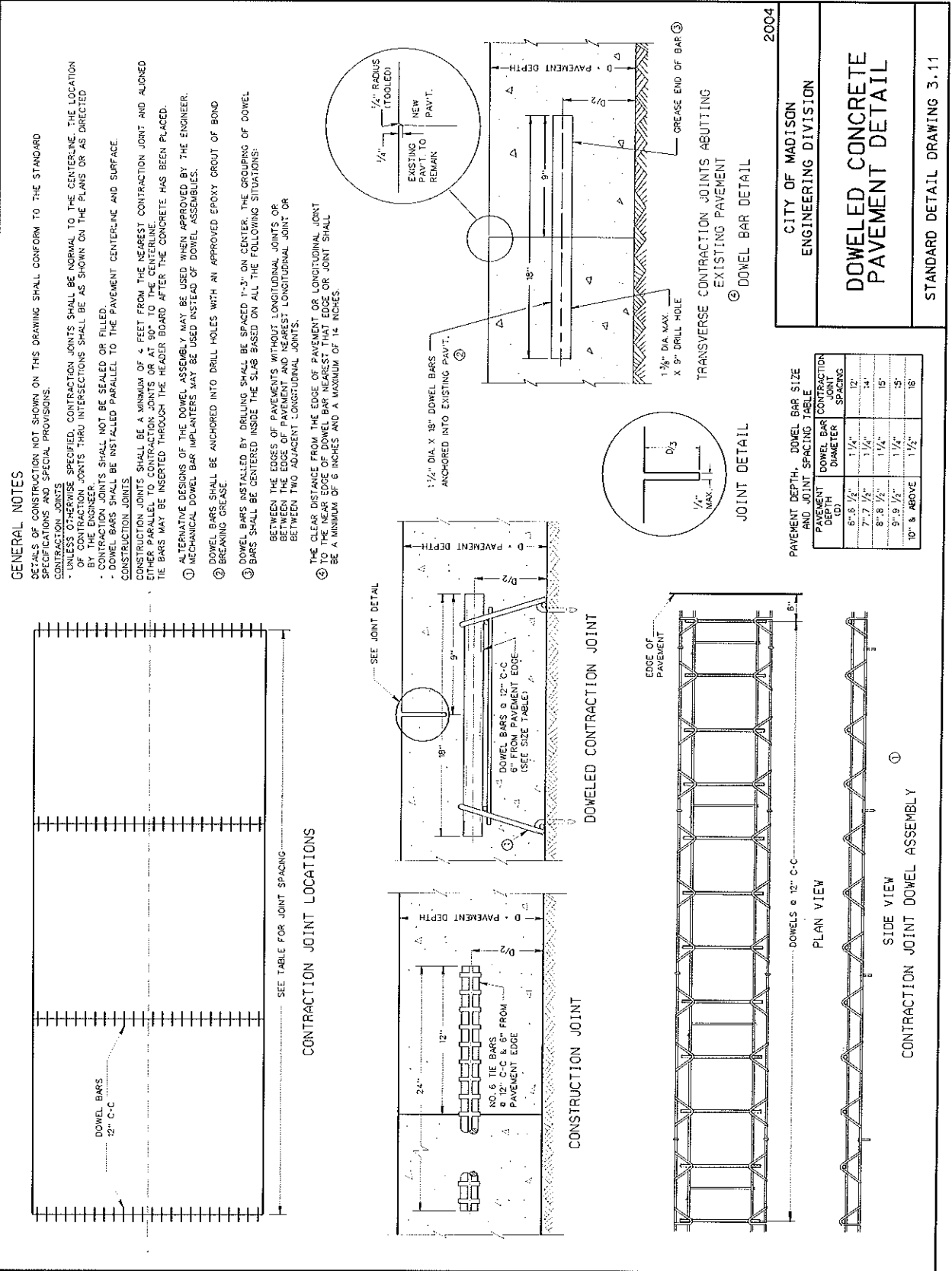

- 1) Sta 10+90.13 -45.57'Lt
- 2) Sta 11+05.26 -27.00'Lt
- 3) Sta 11+31.62 -16.00'Lt
- 15.29 TC/PT

- 4) Sta 11+87.69 -29.75'Lt
- 5) Sta 11+98.85 -51.29'Lt

REVISED 09/20/06 MWC

PROJECT NO. 53B2046

SHEET NO.  
P-101

PLAN AND PROFILE

SOUTH FIRST STREET CITY OF MADISON

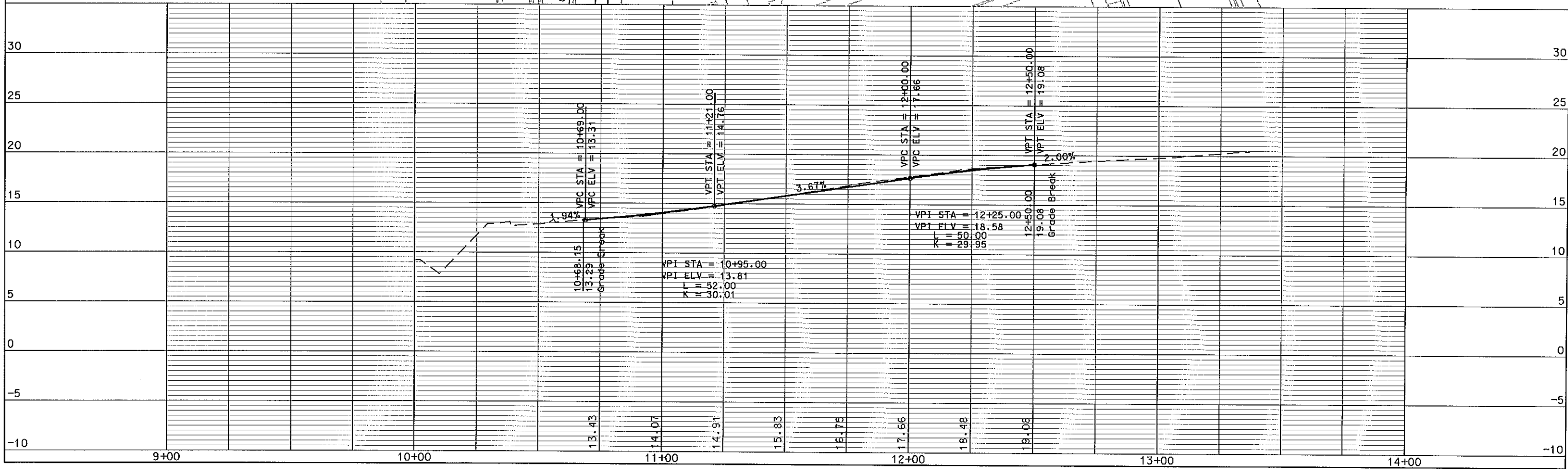
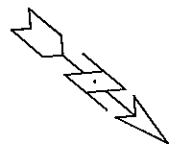
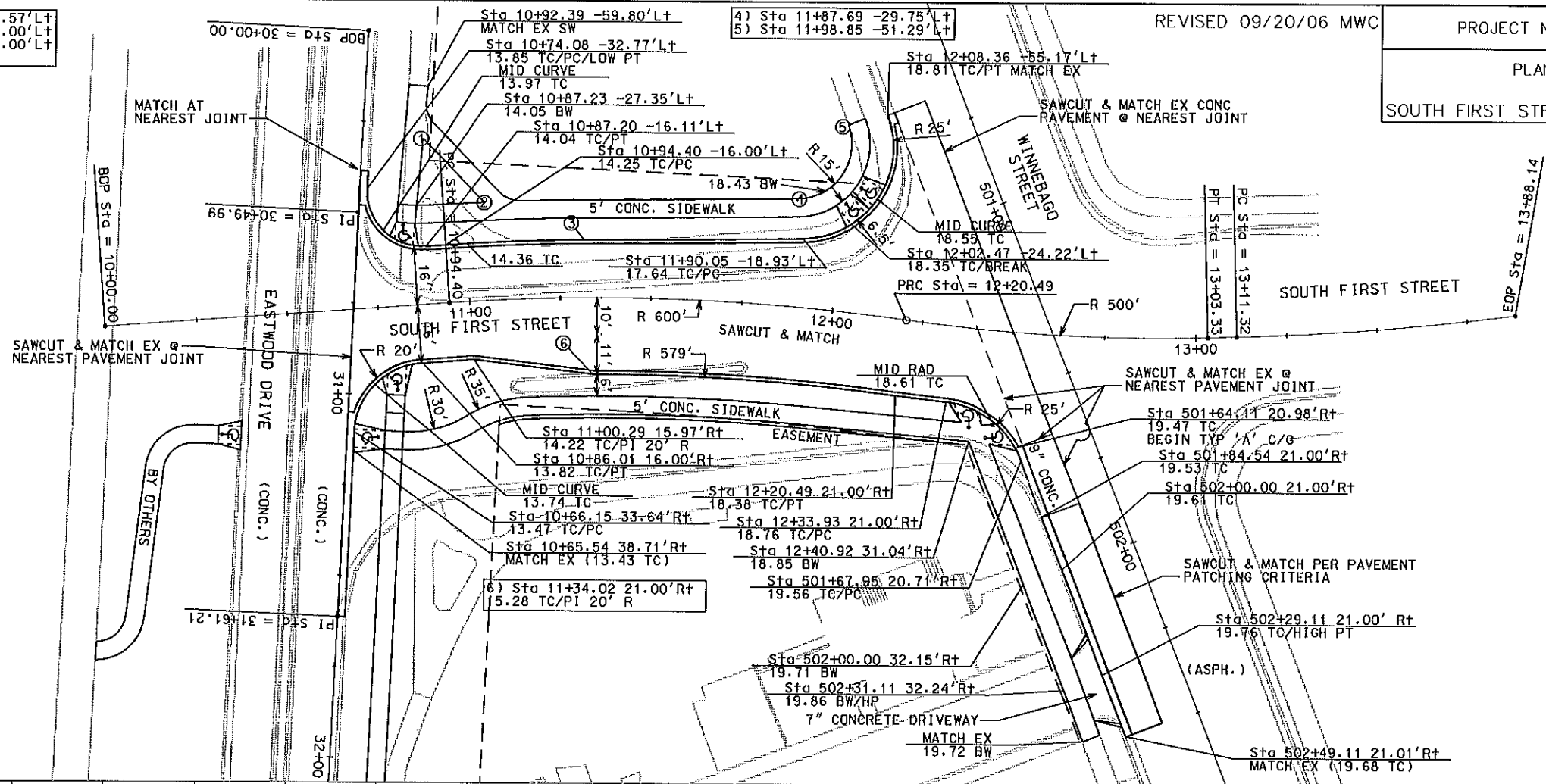

PLOT SCALE: .....  
 PLOT NAME: .....  
 REV. DATE: .....  
 ORIGINATOR: CITY OF MADISON - STREETS DIVISION

REVISED 09/20/06 MWC

PROJECT NO. 53B2046

SHEET NO.  
P-102

PLAN AND PROFILE  
EASTWOOD DRIVE CITY OF MADISON

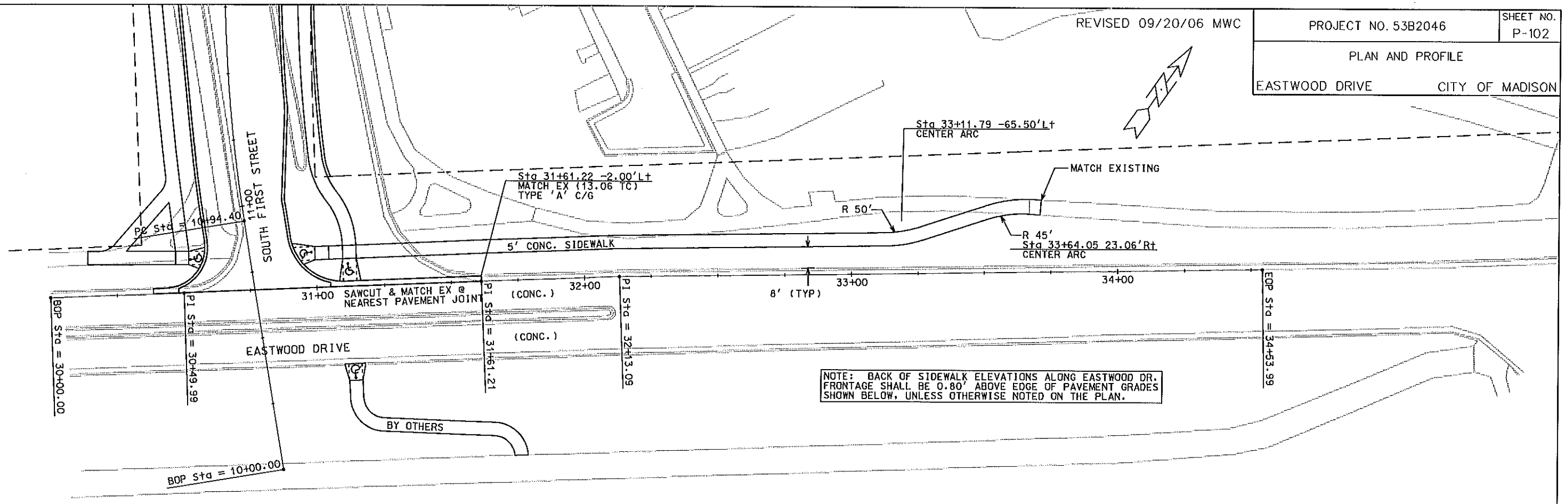

NOTE: BACK OF SIDEWALK ELEVATIONS ALONG EASTWOOD DR. FRONTAGE SHALL BE 0.80' ABOVE EDGE OF PAVEMENT GRADES SHOWN BELOW, UNLESS OTHERWISE NOTED ON THE PLAN.

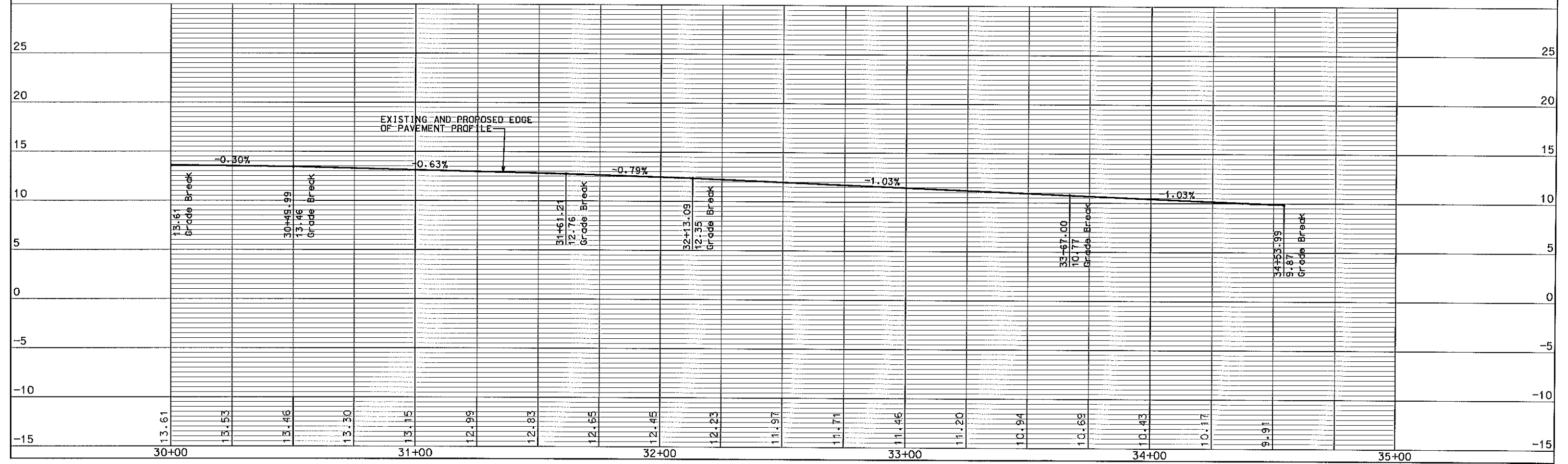

PLOT SCALE: .....

PLOT NAME: .....

REV. DATE: .....

ORIGINATOR: DIIY\_02\_MADISON\_STREETS\_DIVISION

REVISED 09/20/06 MWC

PROJECT NO. 53B2046

SHEET NO.  
P-103

CONCRETE PAVEMENT LAYOUT PLAN

SOUTH FIRST STREET CITY OF MADISON

PLOT SCALE: \_\_\_\_\_  
PLOT NAME: \_\_\_\_\_  
REV. DATE: \_\_\_\_\_

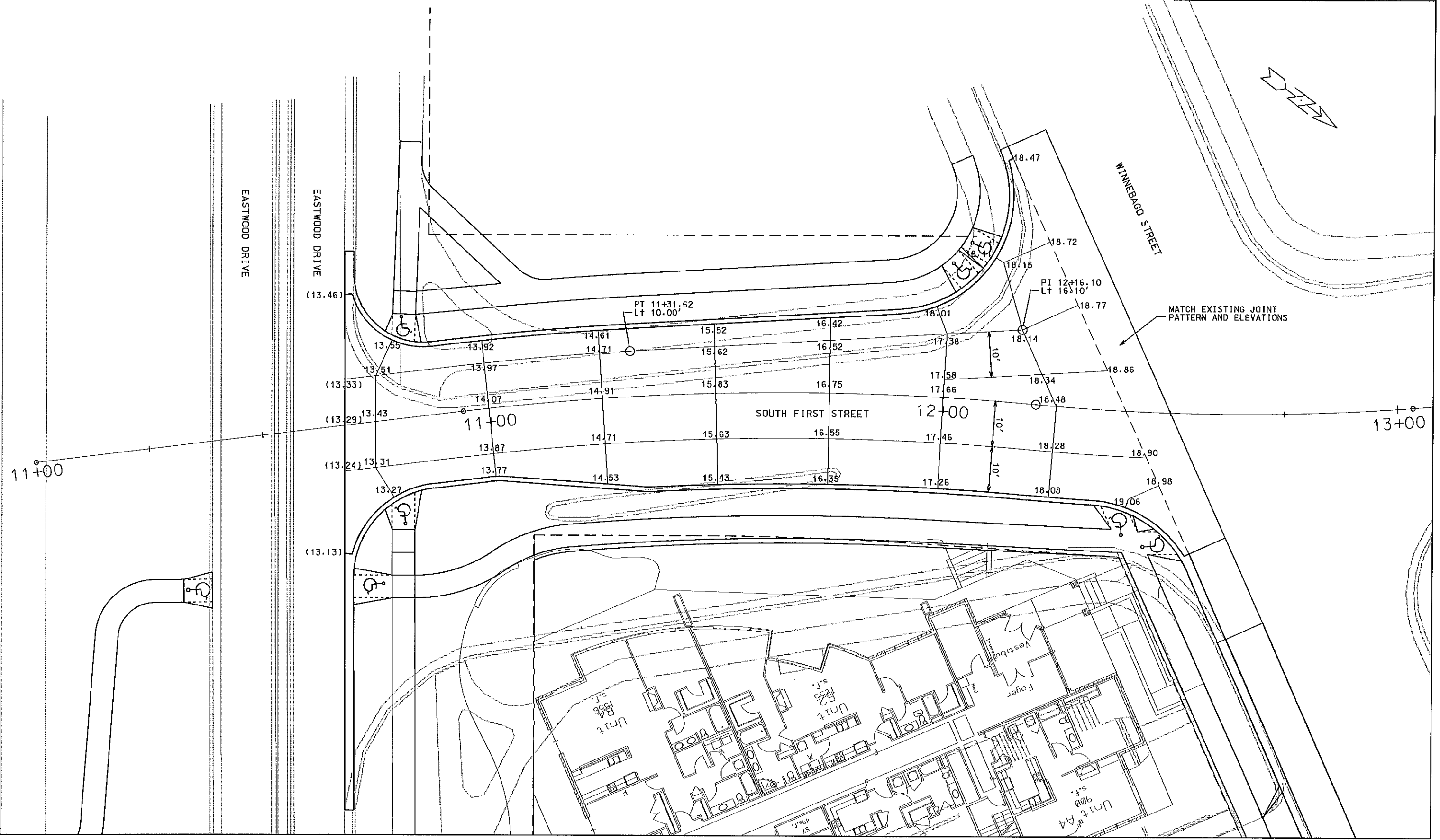

ORIGINATOR: CITY OF MADISON, STREETS DIVISION

- AS = ADJUST SEWER ACCESS STRUCTURE
- AI = ADJUST INLET
- RCB = REMOVE CATCH BASIN
- RS = REMOVE SEWER ACCESS STRUCTURE
- RI = REMOVE INLET
- RP = REMOVE STORM PIPE
- PP = PIPE PLUG

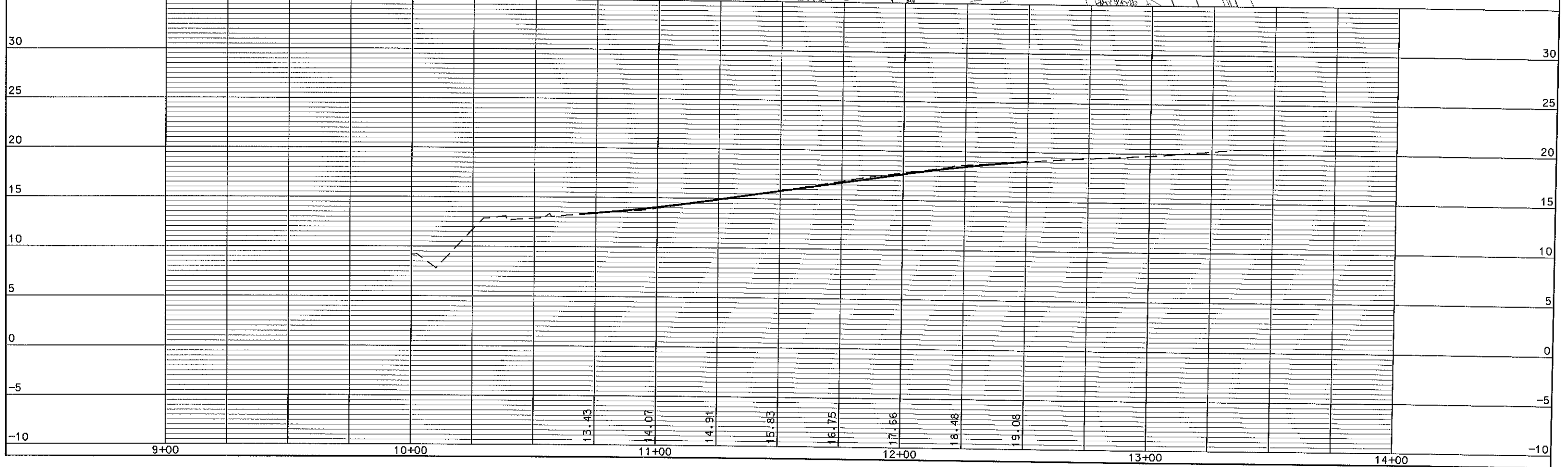
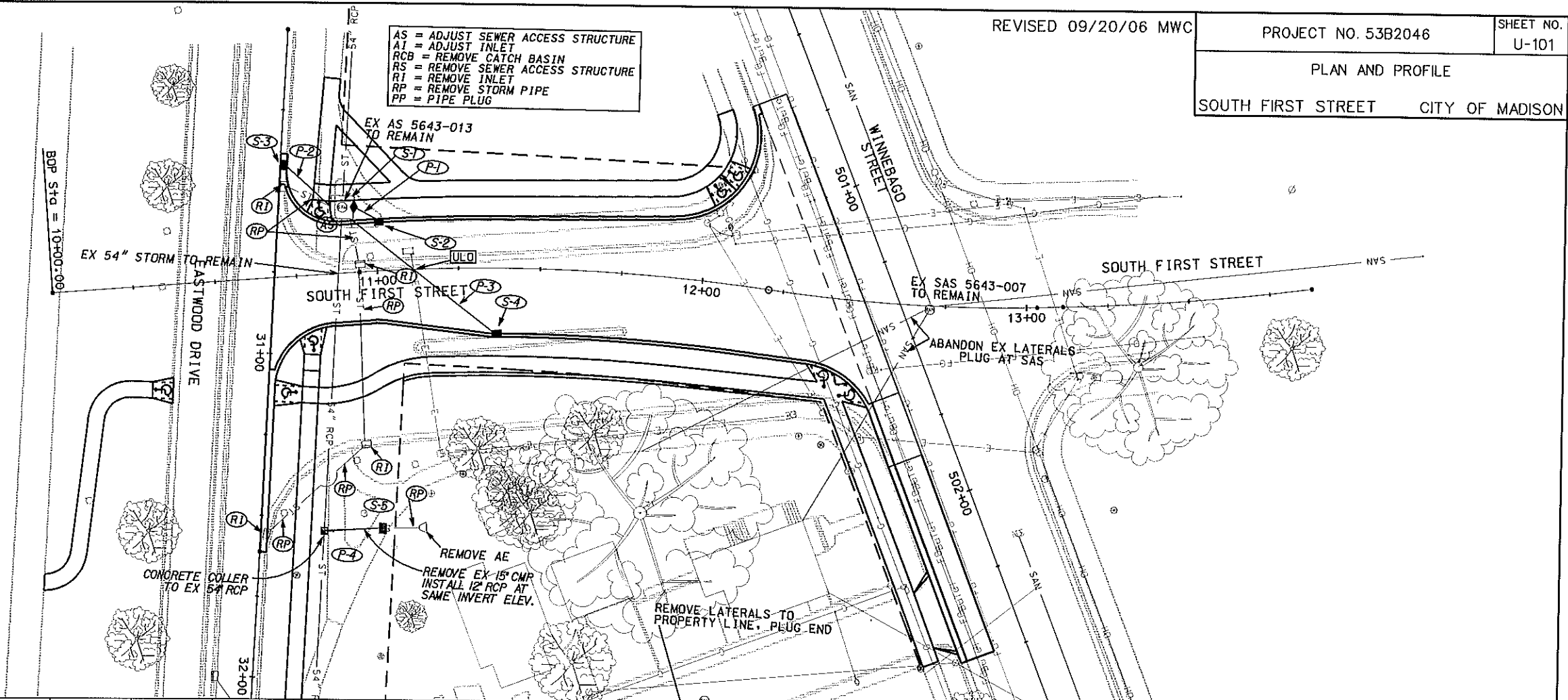

ORIGINATOR: CITY OF MADISON, STREETS DIVISION

REV. DATE: PLOT NAME: PLOT SCALE:



- AS = ADJUST SEWER ACCESS STRUCTURE
- AI = ADJUST INLET
- RCB = REMOVE CATCH BASIN
- RS = REMOVE SEWER ACCESS STRUCTURE
- RI = REMOVE INLET
- RP = REMOVE STORM PIPE
- PP = PIPE PLUG

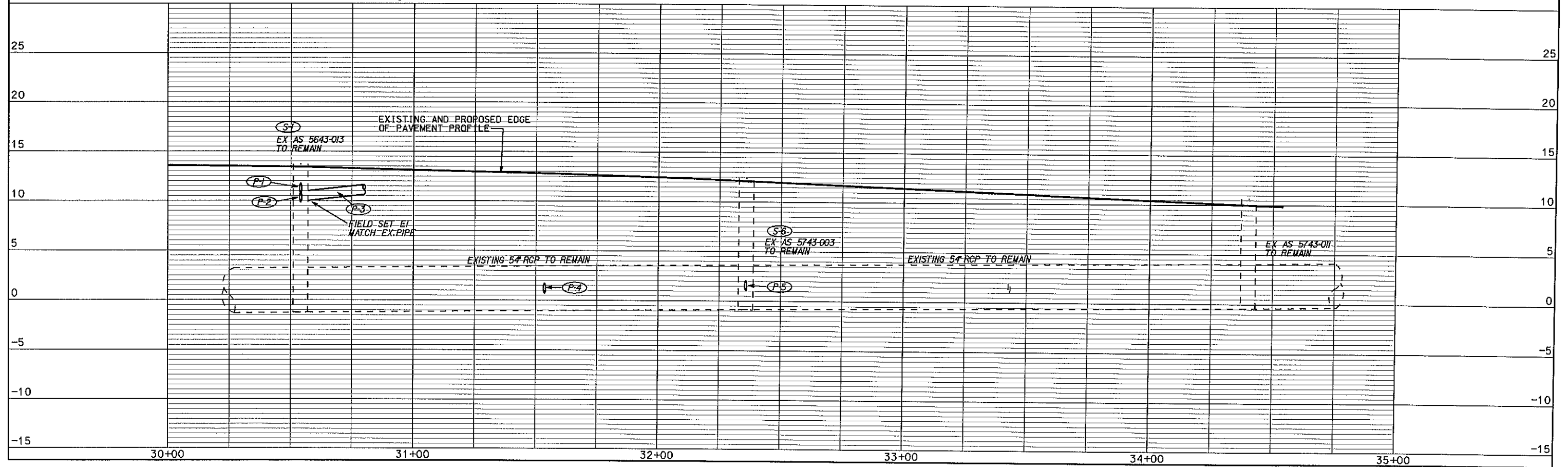
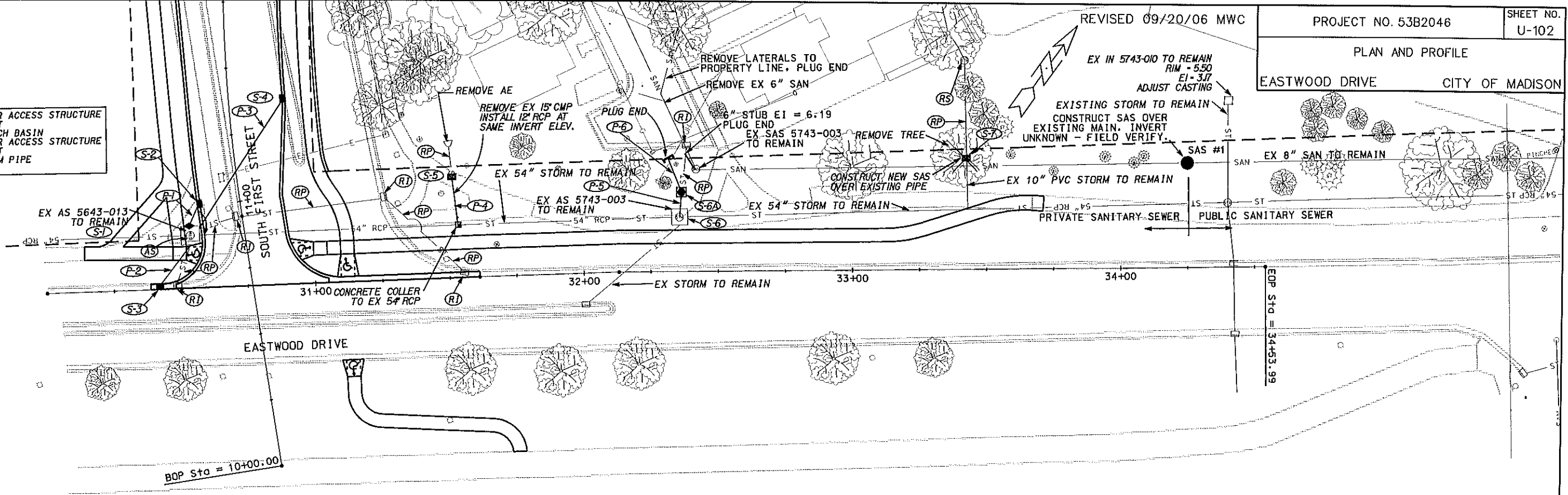

ORIGINATOR: CITY OF MADISON, STREETS DIVISION

PLOT SCALE: .....  
 PLOT NAME: .....  
 REV. DATE: .....

# STORM SEWER SCHEDULE

## ALIGNMENT CODES:

'E' = EASTWOOD DRIVE  
'F' = FIRST STREET

KENNEDY POINT CONDOS  
PROJECT NO. 53B2046

SHEET NO.  
U-103

STORM SEWER SCHEDULE

CITY OF MADISON

### STRUCTURES

STRUC. NO.	STATION	LOCATION (OFFSET)	TYPE	TOP OF CASTING	E.I.	DEPTH	NOTES
S-1	30'F+54.00	19.8' LT	EX AS 5643-013	13.70	-1.23	14.93	EX TO REMAIN, ADJUST CASTING
S-2	11'E+01.21	15.50' LT	H INLET	14.40	10.85	3.55	W/ R-3067
S-3	30'E+42.00	1.50' LT	H INLET	13.85	10.06	3.79	LP; FP; W/ R-3067
S-4	11'F+36.83	20.50' LT	H INLET	15.38	12.00	3.38	W/ R-3067-V
S-5	31'E+51.90	37.50' LT	H INLET	16.50	FIELD	FIELD	MATCH EX PIPE INVERTS; W/ R-1878-B7G
S-6	32'E+35.80	20.3' LT	EX AS 5743-003	12.40	-1.40	13.80	EX TO REMAIN; PLUG EX NW PIPE, TAP FOR P-4
S-6A	32'E+36.50	29.5' LT	3'X3' SAS	11.35	1.13	10.22	W/ R-1550
S-7	33'E+42.50	41.5' LT	H INLET	9.50	-0.37	9.87	W/ R-1878-B7G; FIELD VERIFY EX 10" EI

### PIPES

PIPE NO.	FROM (DNSTM)	TO (UPSTM)	LGTH (FT)	DISCH. E.I.	INLET E.I.	SLOPE (%)	PIPE SIZE	TYPE	NOTES
P-1	S-1	S-2	9	10.75	10.85	1.11%	12"	RCP	TAP EX STRUCTURE
P-2	S-1	S-3	19	9.87	10.06	1.00%	12"	RCP	TAP EX STRUCTURE
P-3	S-1	S-4	57	10.00	12.00	3.51%	12"	RCP	USE EXISTING PIPE OPENNING, EI APPROX.
P-4	EX 54"	S-5	18	FIELD	FIELD	FIELD	12"	RCP	MATCH EX 15" CMP ELEV & SLOPE
P-5	S-6	S-6A	9	1.08	1.13	0.56%	12"	RCP	---
P-6	S-1	PLUG	14	1.13	1.87	5.29%	12"	RCP	PLUG END

### SPECIFIC NOTES

(1) SEE STANDARD DETAIL DRAWINGS 5.7.10

### STANDARD NOTES:

-ABBREVIATIONS: AE = APRON ENDWALL; RCP = REINFORCED CONCRETE PIPE; HERCP = HORIZONTAL ELLIPTICAL REINFORCED CONCRETE PIPE; DNA = DOES NOT APPLY; SAS = SEWER ACCESS STRUCTURE; LP = LOW POINT INLET STRUCTURE; FP = FIELD POURED STRUCTURE; TR = TOP OF CONCRETE ROOF; NCM = NO CROWN MATCH FOR PIPES

- APPROXIMATE DISCHARGE E.I. GIVEN, ADJUST E.I. AND PIPE SLOPE IN THE FIELD.

-TOP OF CASTING GRADE GIVEN IS THE TOP OF CURB FOR INLET STRUCTURES AND THE FLOWLINE OF THE CLOSED CASTING FOR SAS's.

-TOP OF CONCRETE ROOF (TR) IS 1.25' BELOW TOP OF CASTING UNLESS OTHERWISE NOTED.

-ALL REINFORCED CONCRETE PIPES TO BE CLASS III UNLESS OTHERWISE NOTED.

-SURVEYOR TO CONFIRM THAT ALL INLET STATION / OFFSETS LINE UP WITH PROPOSED CURB AND GUTTER.

-ALL STRUCTURES CALLED OUT AS FIELD POURED SHALL BE FIELD POURED. ALL OTHER STRUCTURES (NOT INDICATED AS FIELD POURED) SHALL BE SUBMITTED TO CITY ENGINEERING FOR APPROVAL IF PRECAST STRUCTURES ARE PREFERRED. CONTACT JANET GEBERT OF CITY ENGINEERING AT (608) 261-9688 FOR PRECAST APPROVALS, OR FAX SHOP DRAWINGS TO (608)264-9275.

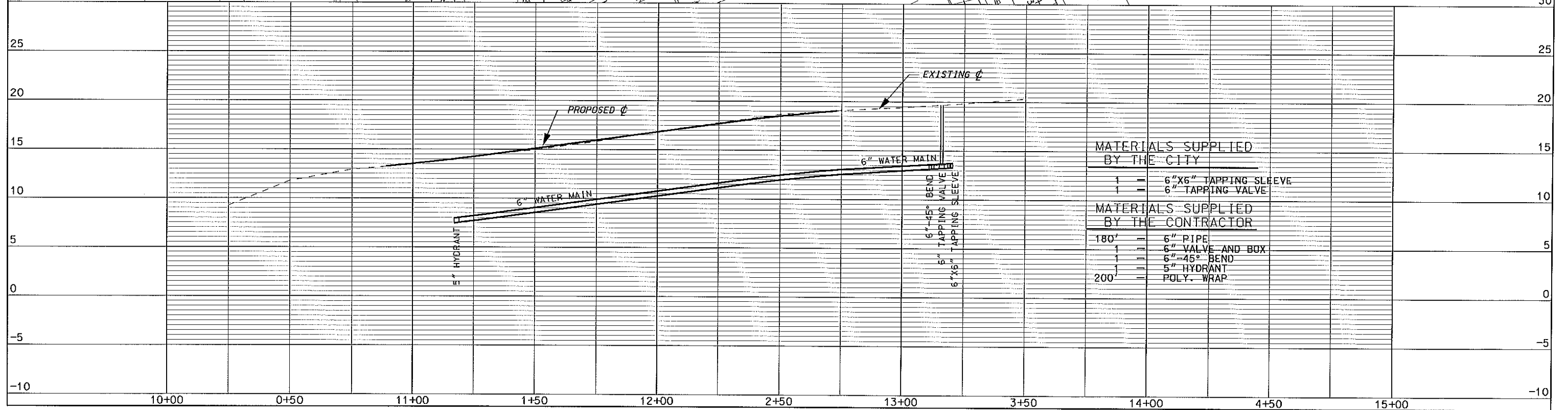
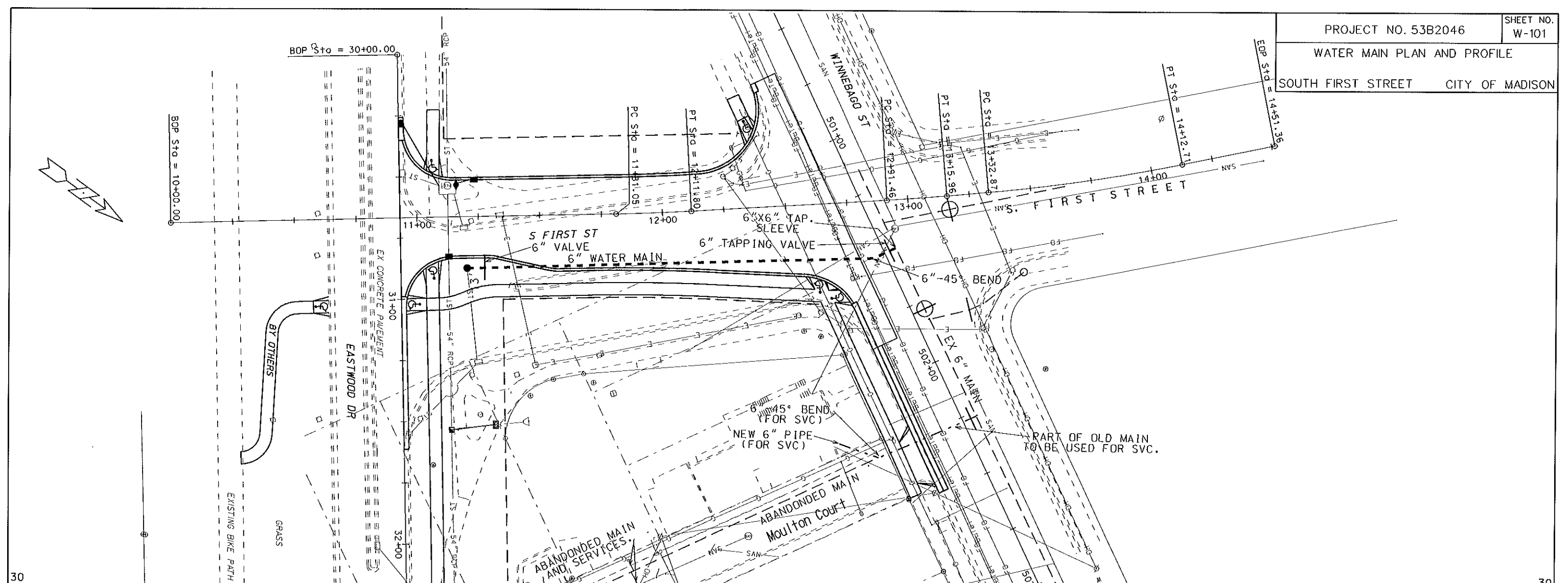

MATERIALS SUPPLIED BY THE CITY	
1	6"X6" TAPPING SLEEVE
1	6" TAPPING VALVE
MATERIALS SUPPLIED BY THE CONTRACTOR	
180'	6" PIPE
1	6" VALVE AND BOX
1	6"-45° BEND
1	5" HYDRANT
200'	POLY. WRAP

PLOT SCALE: .....  
 PLOT NAME: .....  
 REV. DATE: .....  
 ORIGINATOR: CITY OF MADISON, STREETS DIVISION