

Madison, Wisconsin

# CITY OF MADISON

## CITY ENGINEERING DIVISION

### DEPARTMENT OF PUBLIC WORKS

#### PLAN OF PROPOSED IMPROVEMENT

PUBLIC IMPROVEMENT PROJECT APPROVED

JULY 21, 2015

BY THE COMMON COUNCIL  
OF MADISON, WISCONSIN

PUBLIC IMPROVEMENT DESIGN  
APPROVED BY:

  
City Engineer 12/10/15  
Date

#### INDEX OF SHEETS

| SHEET NO. | TITLE            |
|-----------|------------------|
| 1         | NOTES & DETAILS  |
| DI-D2     | STREET PLAN      |
| U1        | UTILITIES PLAN   |
| E1-E2     | ELECTRICAL PLAN  |
| L1        | LANDSCAPING PLAN |

## 110 N. LIVINGSTON STREET – REYNOLDS REDEVELOPMENT

CITY PROJECT NO. 53B2412  
MUNIS NO. 11171

CONTRACT NO. 2412

STREET  
DESIGNED BY:

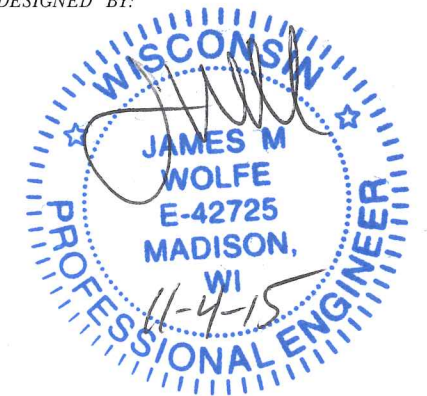

STORM SEWER  
DESIGNED BY:



ELECTRICAL DESIGNED  
DESIGNED BY:

| CONVENTIONAL SIGNS                 |         |
|------------------------------------|---------|
| FIELD VERIFY ALL UTILITY LOCATIONS |         |
| GAS                                | — G —   |
| STORM SEWER                        | — ST —  |
| SANITARY SEWER                     | — SAN — |
| WATER                              | — W —   |
| OVERHEAD ELECTRIC                  | — OH —  |
| POWER POLE                         | □       |

PROJECT  
LOCATION

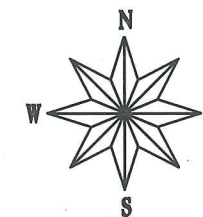
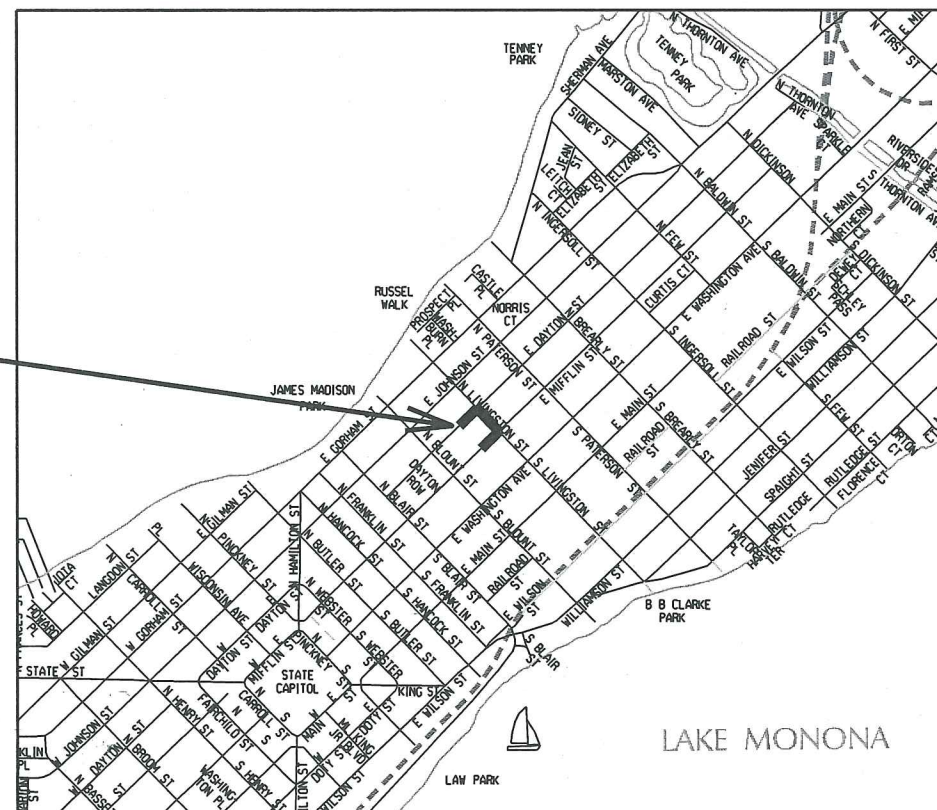

#### NOTES:

ALL GUTTERS SHALL DRAIN WITH A MINIMUM GRADE OF 0.50% TOWARD STORM SEWER INLETS.

SIDEWALK RAMPS AND CURB THRU SIDEWALK RAMPS SHALL HAVE A MAXIMUM SLOPE OF 1" PER 12". SIDEWALK AND CURB RAMPS SHALL BE CONSTRUCTED WITH A SIDE SLOPE OF 2.00%. SIDEWALK SHALL HAVE A MINIMUM LONGITUDINAL SLOPE OF 0.50% AND A MAXIMUM LONGITUDINAL SLOPE OF 5.00%.

PLOT SCALE:

PLOT NAME:

REV. DATE:

ORIGINATOR: CITY OF MADISON, STREETS DIVISION

CONTRACTOR/DEVELOPER SHALL SUBMIT A TRAFFIC CONTROL PLAN TO CITY TRAFFIC ENGINEERING AT LEAST 10 WORKING DAYS PRIOR TO THE START OF WORK. WORK WITHIN THE RIGHT-OF-WAY SHALL NOT BEGIN UNTIL THE TRAFFIC CONTROL PLAN IS APPROVED.

ANY PAVEMENT MARKINGS THAT ARE REMOVED OR DAMAGED SHALL BE REPLACED BY THE DEVELOPER/CONTRACTOR AS DIRECTED BY CITY TRAFFIC ENGINEERING.

THE LOCATION AND INFORMATION FOR PROPOSED NEW TREES, IN THE PUBLIC RIGHT OF WAY OR ON PUBLIC LANDS ARE APPROXIMATE AND ARE SHOWN FOR REFERENCE ONLY.

CONTRACTOR SHALL CONTACT DEAN KAHL WITH CITY FORESTRY (266-4891 OR 266-4816) AT LEAST ONE WEEK PRIOR TO PLANTING TO ALLOW FORESTRY TO MARK THE PLANTING SITES AND REVIEW PLANTING SPECIFICATIONS WITH THE LANDSCAPING CONTRACTOR. TREE PLANTING WITHIN THE PUBLIC RIGHT OF WAY OR ON PUBLIC LANDS SHALL BE APPROVED BY THE CITY FORESTER PRIOR TO INSTALLATION.

NO TREES IN THE RIGHT OF WAY OR ON PUBLIC LANDS SHALL BE TRIMMED, PRUNED, REMOVED OR ADVERSELY AFFECTED IN ANY WAY UNTIL THE DEVELOPER HAS RECEIVED WRITTEN PERMISSION FROM THE CITY ENGINEER OR CITY FORESTER. SAID WRITTEN PERMISSION SHALL INCLUDE LANGUAGE INDICATING THAT SECTION 10.101 OF THE MADISON GENERAL ORDINANCES AND ADMINISTRATIVE PROCEDURE MEMORANDUM NO. 6-2, REFERING TO NOTIFICATION OF PROPERTY OCCUPANTS AND/OR OWNERS, HAS BEEN COMPLIED WITH.

SEE SHEET L-1 FOR ADDITIONAL TREE NOTES.

ALL PAVEMENT WITHIN THE RIGHT-OF-WAY SHALL BE TYPE B PAVEMENT.

ALL GUTTERS SHALL DRAIN WITH A MINIMUM GRADES OF 0.5% TOWARD STORM SEWER INLETS.

THE CROSS SLOPE OF SIDEWALKS AND BARRIER FREE SIDEWALK CURB RAMPS SHALL BE 1.5%. THE LONGITUDINAL GRADE OF BARRIER FREE SIDEWALK CURB RAMPS SHALL NOT EXCEED 8.33%. ALL SIDEWALK RAMPS SHALL BE CONSTRUCTED ACCORDING TO S.D.D. 3.03. AT ALL OTHER LOCATIONS THE LONGITUDINAL GRADE OF SIDEWALKS SHALL NOT EXCEED 5.0 % OR THE ADJACENT STREET GRADE WHICHEVER IS GREATER NOR BE LESS THAN 0.4% AND SHALL DRAIN TOWARD STORM SEWER INLETS. SIDE SLOPES WITHIN TEN FEET OF A PUBLIC SIDEWALK SHALL NOT EXCEED 4:00:1. ALL SIDEWALK AND SIDEWALK RAMP ELEVATIONS AND GRADES SHALL BE FIELD VERIFIED AND SET TO COMPLY WITH THE CITY OF MADISON STANDARD SPECIFICATIONS AND THE A.D.A. GUIDELINES.

OBTAIN A PRINT OUT OF THE ALIGNMENT FROM THE CITY ENGINEER PRIOR TO STAKING THIS PROJECT.

CURB STATION AND OFFSETS SHALL BE TO THE FACE OF CURB UNLESS OTHERWISE INDICATED. CURB ELEVATIONS SHALL BE TO THE TOP OF CURB (OR EXTENDED TOP OF CURB FOR DRIVEWAYS OR RAMPS) UNLESS OTHERWISE INDICATED.

POWER POLES AND OTHER OBSTRUCTIONS SHALL BE MOVED TO PROVIDE 2 FEET MINIMUM OF CLEAR DISTANCE FROM ANY FACE OF CURB OR EDGE OF SIDEWALK.

ANY INFORMATION SHOWN ON THIS PLAN, WHICH IS NOT PART OF THIS PROJECT, IS PRELIMINARY AND NOT FOR CONSTRUCTION.

THERE MAY BE EXISTING UTILITIES OR OTHER FEATURES WHICH ARE EITHER NOT SHOWN OR SHOWN INCORRECTLY ON THIS PLAN. IT IS THE RESPONSIBILITY OF THE DEVELOPER TO LOCATE AND IDENTIFY ALL UTILITIES AND TOPOGRAPHY WHICH MAY AFFECT THE CONSTRUCTION OF THESE IMPROVEMENTS.

ALL PERMANENT SIGNING AND POSTING WILL BE DETERMINED AND PROVIDED BY THE TRAFFIC ENGINEERING DIVISION, FOLLOWING CONSTRUCTION OF THESE IMPROVEMENTS.

THE DEVELOPER SHALL PROVIDE, INSTALL AND MAINTAIN ALL STREET END BARRICADES, SIGNING AND TRAFFIC CONTROL, AS REQUIRED BY THE CITY TRAFFIC ENGINEER.

PAVEMENT SAWCUTS SHALL BE AS DIRECTED BY THE CITY CONSTRUCTION ENGINEER. SAWCUTS SHOWN ON THE PLAN ARE APPROXIMATE.

DAMAGE TO ANY EXISTING CURB, PAVEMENT, SIDEWALK, ETC. THAT IS TO REMAIN SHALL BE REPAIRED BY THE DEVELOPER/CONTRACTOR AS DIRECTED BY THE ENGINEER.

PLOT SCALE: \_\_\_\_\_

PLOT NAME: \_\_\_\_\_

REV. DATE: \_\_\_\_\_

ORIGINATOR: CITY OF MADISON, STREETS DIVISION

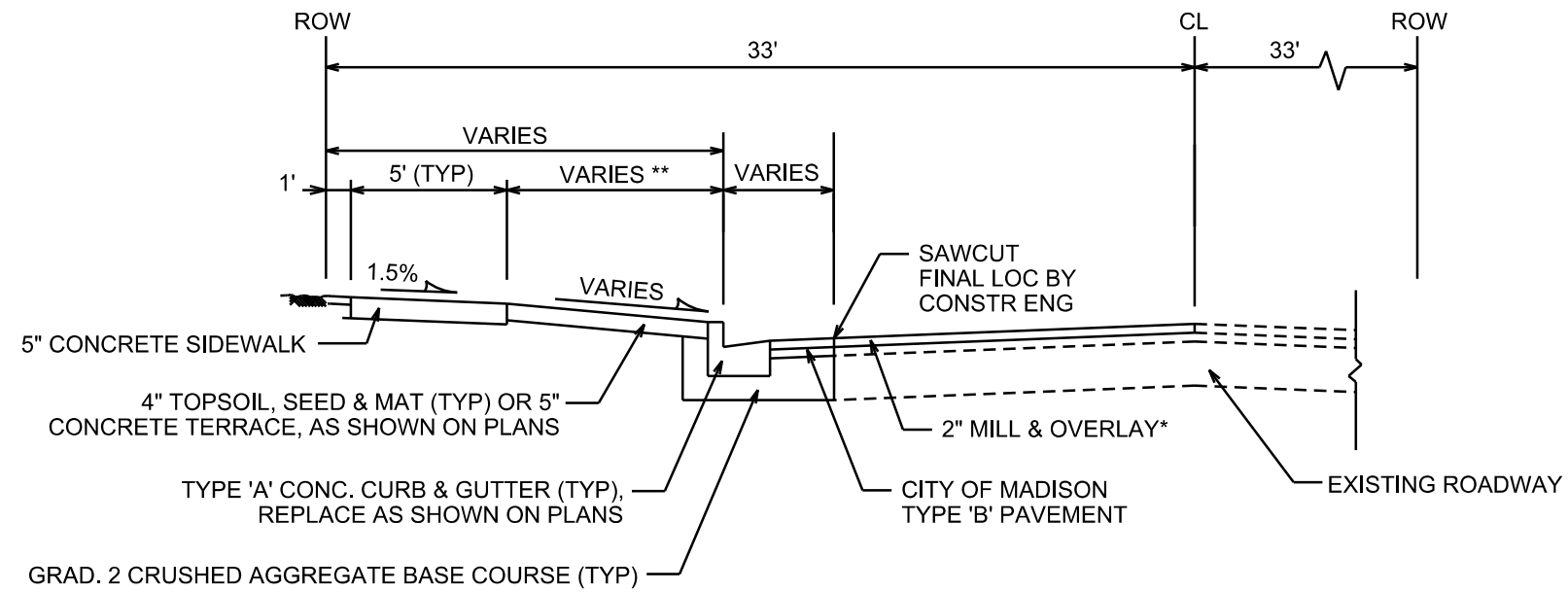

### TYPICAL SECTION

E. MIFFLIN STREET  
N. LIVINGSTON STREET  
E. DAYTON STREET  
NOT TO SCALE

**NOTES:**

\* MILL & OVERLAY LIMITS ARE APPROXIMATE. PATCH PAVEMENT PER CITY'S PATCHING CRITERIA. MILL & OVERLAY MAY NOT BE NECESSARY IF PAVEMENT IS UNDAMAGED, AS DECIDED BY THE CONSTRUCTION ENGINEER. FINAL MILL & OVERLAY LIMITS TO BE DETERMINED BY THE CONSTRUCTION ENGINEER.

PAVEMENT RATINGS: MIFFLIN = 8, LIVINGSTON = 9, DAYTON = 5

\*\* TERRACE WIDTHS:  
MIFFLIN = 9'; LIVINGSTON = 7'; DAYTON = 9'

PLOT SCALE: \_\_\_\_\_

PLOT NAME: \_\_\_\_\_

REV. DATE: \_\_\_\_\_

ORIGINATOR: CITY OF MADISON, STREETS DIVISION

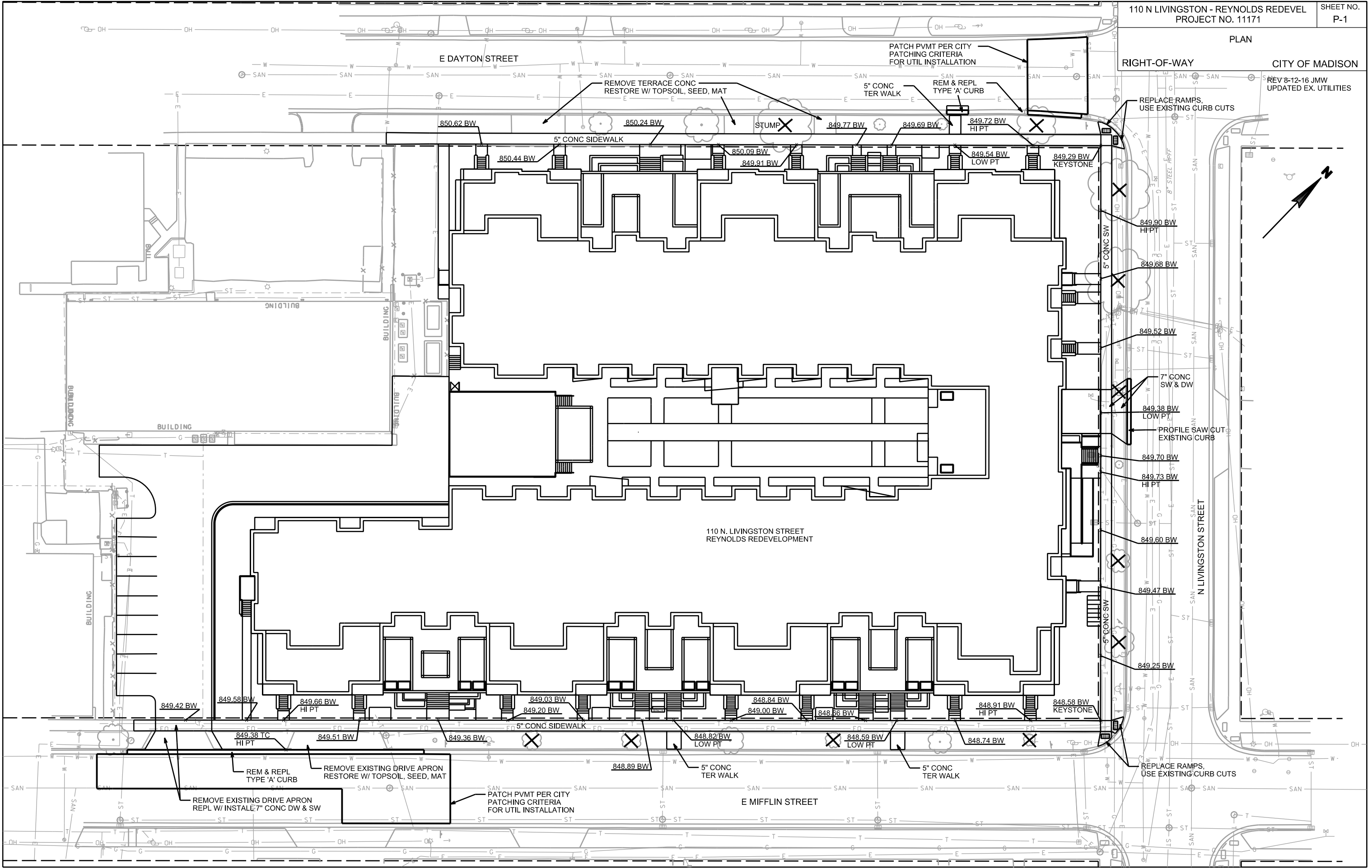

PLOT SCALE: \_\_\_\_\_

PLOT NAME: \_\_\_\_\_

REV. DATE: \_\_\_\_\_

ORIGINATOR: CITY OF MADISON, STREETS DIVISION

SEWER PLAN

CITY OF MADISON  
REV 8-12-16 JMW  
UPDATED EX UTILITIES  
ULO'S ON MIFFLIN ST

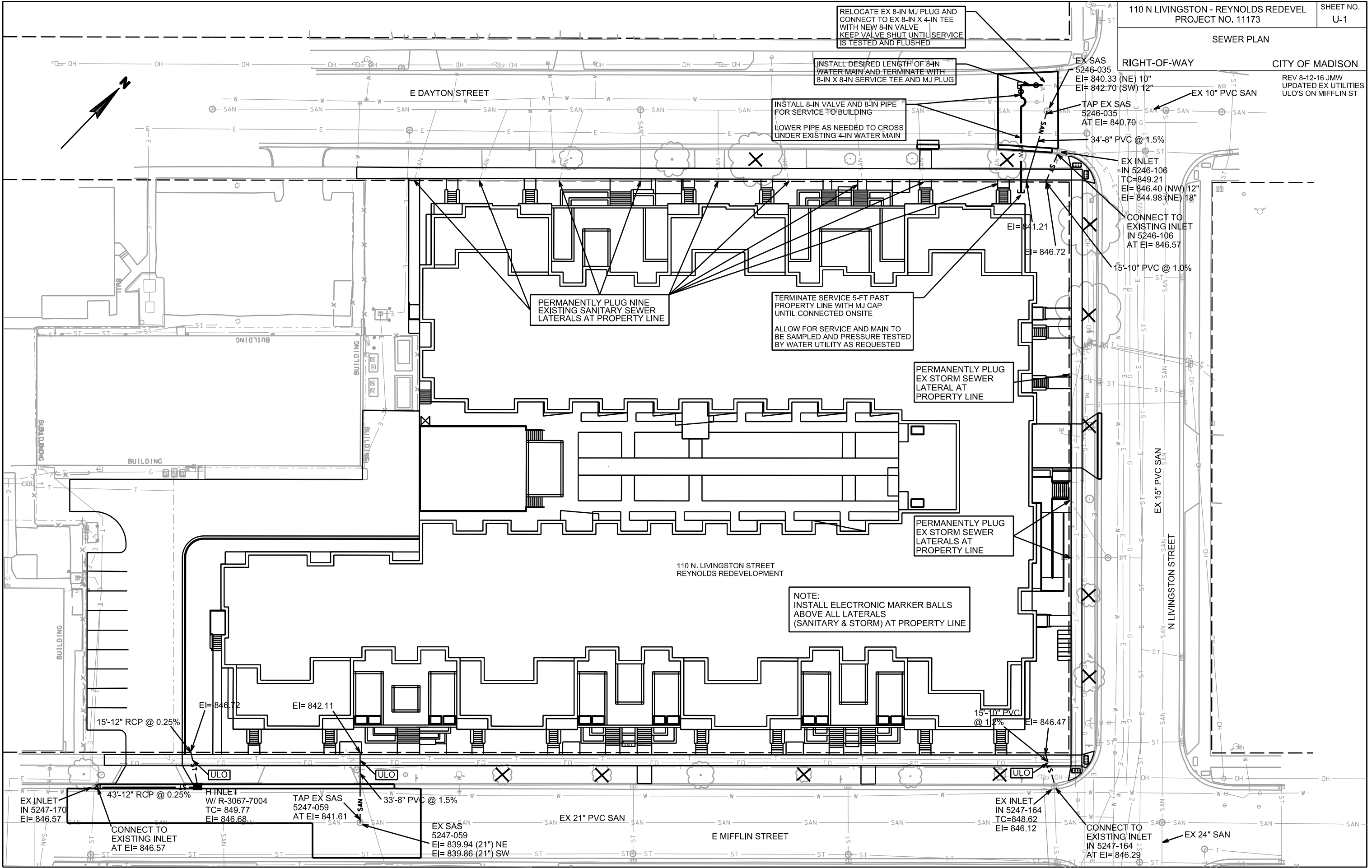

RELOCATE EX 8-IN MJ PLUG AND CONNECT TO EX 8-IN X 4-IN TEE WITH NEW 8-IN VALVE. KEEP VALVE SHUT UNTIL SERVICE IS TESTED AND FLUSHED.

INSTALL DESIRED LENGTH OF 8-IN WATER MAIN AND TERMINATE WITH 8-IN X 8-IN SERVICE TEE AND MJ PLUG.

INSTALL 8-IN VALVE AND 8-IN PIPE FOR SERVICE TO BUILDING. LOWER PIPE AS NEEDED TO CROSS UNDER EXISTING 4-IN WATER MAIN.

PERMANENTLY PLUG NINE EXISTING SANITARY SEWER LATERALS AT PROPERTY LINE.

TERMINATE SERVICE 5-FT PAST PROPERTY LINE WITH MJ CAP UNTIL CONNECTED ONSITE. ALLOW FOR SERVICE AND MAIN TO BE SAMPLED AND PRESSURE TESTED BY WATER UTILITY AS REQUESTED.

PERMANENTLY PLUG EX STORM SEWER LATERAL AT PROPERTY LINE.

PERMANENTLY PLUG EX STORM SEWER LATERALS AT PROPERTY LINE.

NOTE: INSTALL ELECTRONIC MARKER BALLS ABOVE ALL LATERALS (SANITARY & STORM) AT PROPERTY LINE.

EX INLET IN 5247-170 EI= 846.57

CONNECT TO EXISTING INLET AT EI= 846.57

H INLET W/ R-3067-7004 TC= 849.77 EI= 846.68

TAP EX SAS 5247-059 AT EI= 841.61

EX SAS 5247-059 EI= 839.94 (21") NE EI= 839.86 (21") SW

EX INLET IN 5247-164 TC=848.62 EI= 846.12

CONNECT TO EXISTING INLET IN 5247-164 AT EI= 846.29

EX 24" SAN

PLOT SCALE:

PLOT NAME:

REV. DATE:

ORIGINATOR: CITY OF MADISON, STREETS DIVISION

SCALE: 1" = 30'

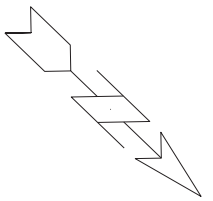

MATCH LINE "A"

MATCH LINE "B"

GENERAL ELECTRICAL NOTES:

1. THE CONTRACTOR SHALL DO ALL WORK IN ACCORDANCE WITH CITY OF MADISON STANDARD SPECIFICATIONS FOR PUBLIC WORKS CONSTRUCTION 2015 EDITION AND ALL ADDENDUMS THERETO. ALL CONDUIT SHALL BE PVC SCHEDULE 80 UNDER PAVEMENT OR SCHEDULE 40 OTHERWISE. PULL WIRE REQUIRED AS PER STANDARD SPECIFICATIONS.
2. THE CONTRACTOR SHALL CALL MIKE CHRISTOPH (266-4767) AT THE TRAFFIC ENGINEERING SHOP AT LEAST 24-HOURS IN ADVANCE OF INSTALLING HANDHOLES OR BURYING CONDUIT TO ARRANGE FOR INSPECTION.
3. THE FOLLOWING CITY FURNISHED MATERIALS ARE TO BE PICKED UP AT THE TRAFFIC TRAFFIC OPERATION SHOP, 1120 SAYLE STREET. NOTIFY DENNIS ROWE AT 266-9034 TWENTY FOUR (24) HOURS PRIOR TO PICKING UP THE MATERIAL.

1 - TYPE-1 ELECTRICAL HANDHOLE

INSTALL 2" PVC CONDUIT

INSTALL 2" PVC CONDUIT

CONNECT TO EXISTING 2" PVC CONDUIT

INSTALL TYPE-1 ELECTRICAL HANDHOLE TO INTERCEPT EXISTING STREETLIGHTING CONDUIT

LEGEND

- PLACE 2 INCH PVC CONDUIT  
SCHDL 40 IN TERRACE  
SCHDL 80 UNDER ROADWAYS AND DRIVEWAYS
- EXISTING STREET LIGHTING CONDUITS
- EXISTING COMMUNICATION CONDUITS WITH FIBER OPTIC CABLE
- ☐ INSTALL CITY FURNISHED TYPE-1 ELECTRICAL HANDHOLE
- ◻ EXISTING ELECTRICAL HANDHOLE

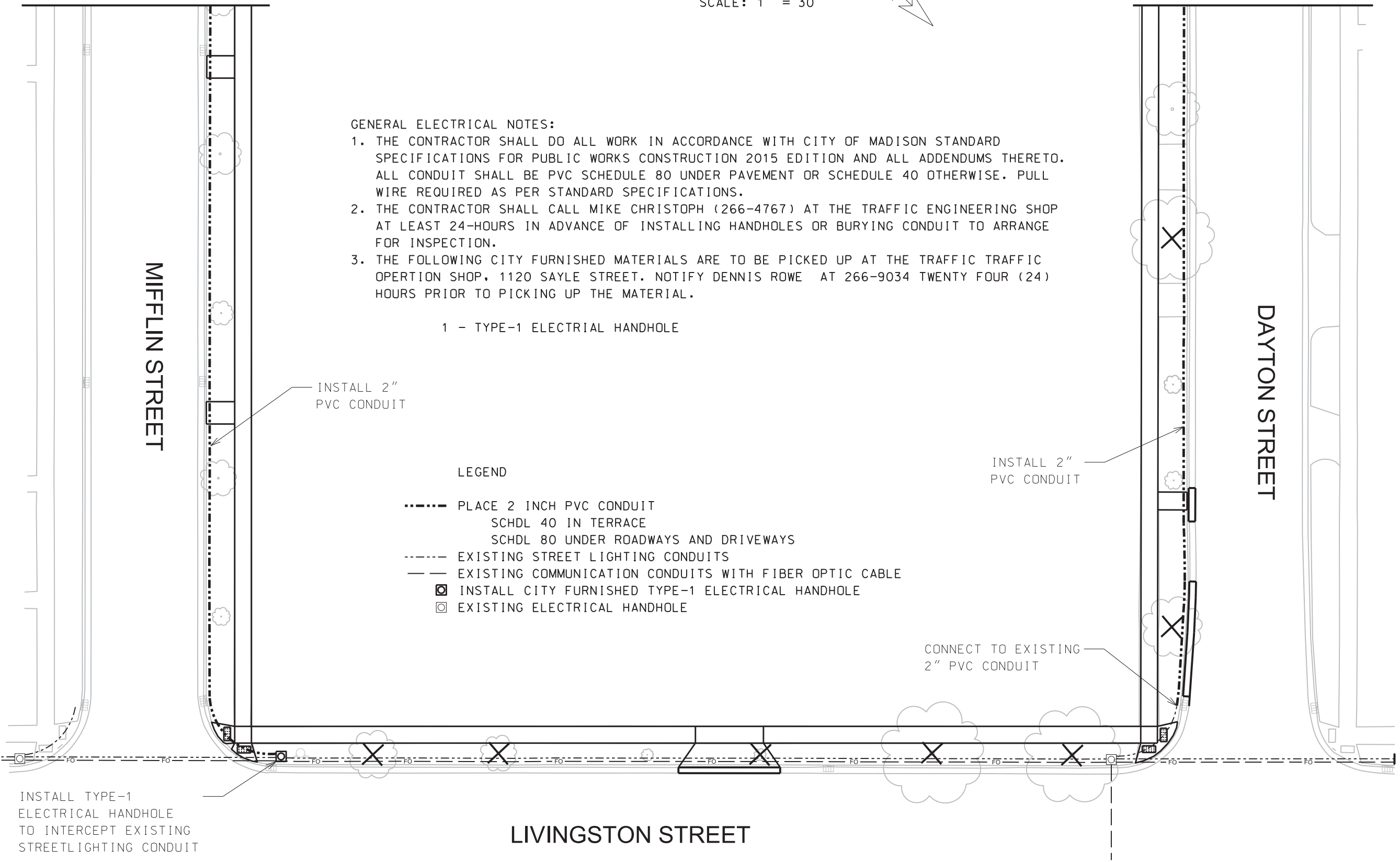

LIVINGSTON STREET

MIFFLIN STREET

DAYTON STREET

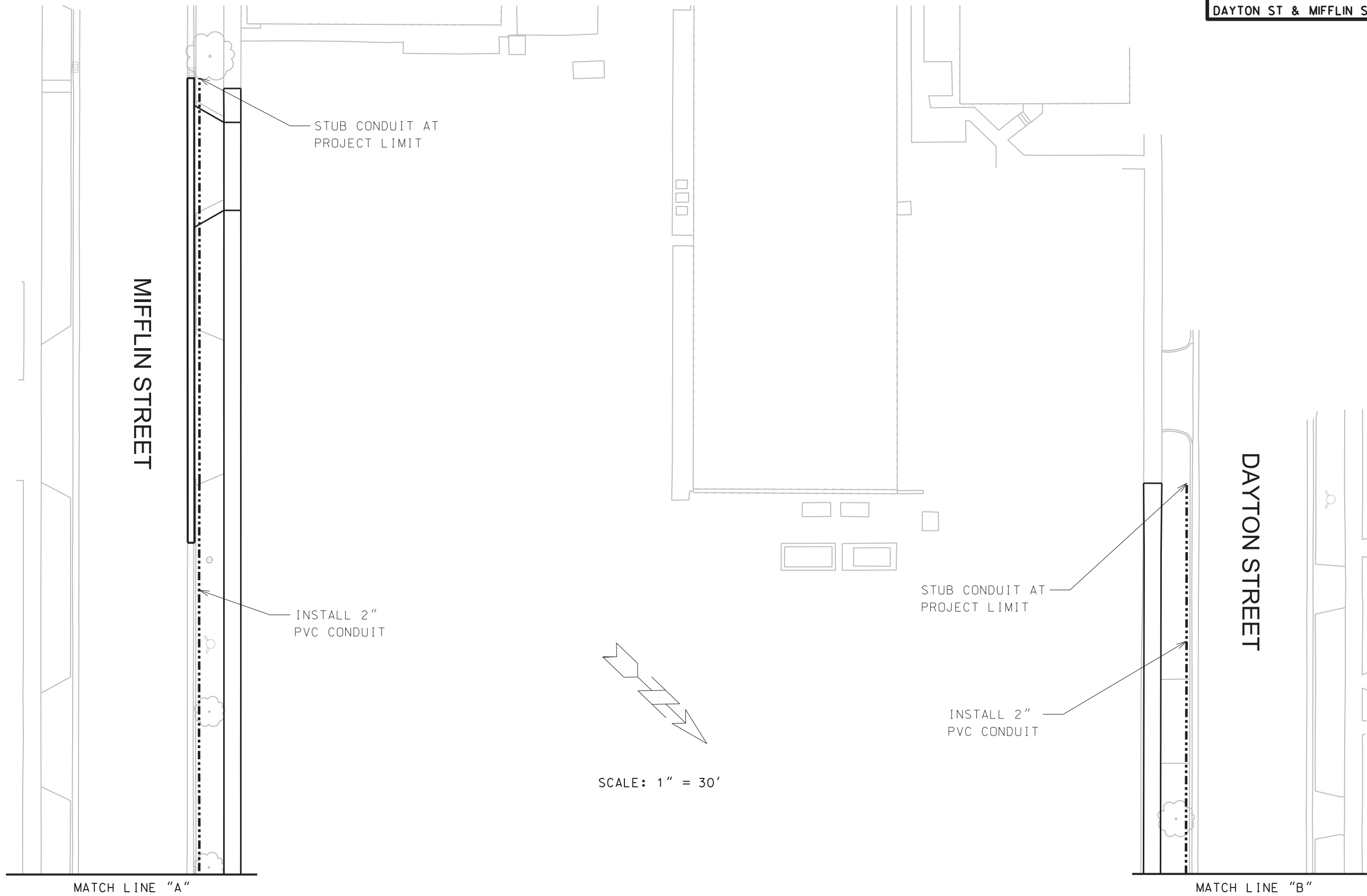

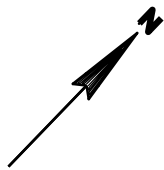

NOTES:

1. SEE SHEET P-1 FOR TREE REMOVALS. PRIOR TO REMOVING ANY TREES, CONTRACTOR SHALL CONTACT CITY FORESTRY (266-4816) TO OBTAIN A TREE REMOVAL PERMIT.
2. ALL EXISTING TREES SHOWN ON THIS PLAN ARE TO REMAIN AND SHALL BE PROTECTED DURING CONSTRUCTION PER CITY STANDARD SPECS. SECTION 107.13. THE CONTRACTOR SHALL INSTALL PROTECTION FENCING A MINIMUM OF 5 FT. FROM EXISTING TREES THAT ARE TO REMAIN. NO EXCAVATION WILL BE ALLOWED IN THIS AREA. IF EXCAVATION MUST BE DONE CLOSER THAN 5 FT TO AN EXISTING TREE, THE CONTRACTOR SHALL CONTACT CITY FORESTRY (266-4816) PRIOR TO THE WORK TO ASSESS THE POTENTIAL IMPACT TO THE TREE.

**LEGEND**

- NHE = NEW HORIZON ELM
- EKCT = ESPRESSO COFFEE TREE
- HB = HACKBERRY
- CSP = CLEVELAND SELECT PEAR
- PSG = PRINCETON SENTRY GINKGO
- SKHL = STREET KEEPER HONEYLOCUST

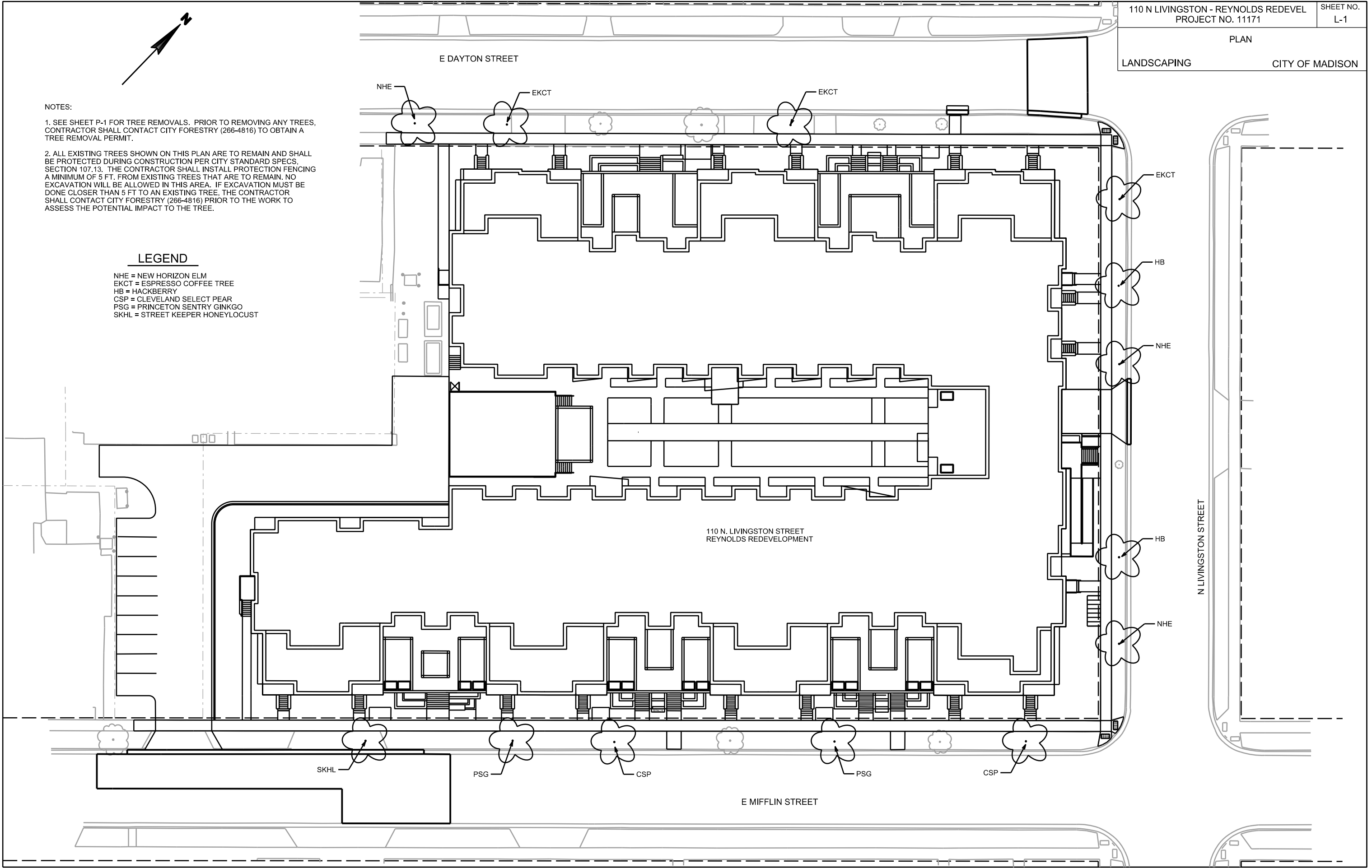

PLOT SCALE: \_\_\_\_\_

PLOT NAME: \_\_\_\_\_

REV. DATE: \_\_\_\_\_

ORIGINATOR: CITY OF MADISON, STREETS DIVISION